

#4 stirrup bars at 2'-0 c. to c.
 Cross-hatched portion is integral concrete curb.

**INTEGRAL CONCRETE CURB
 (BARRIER)**

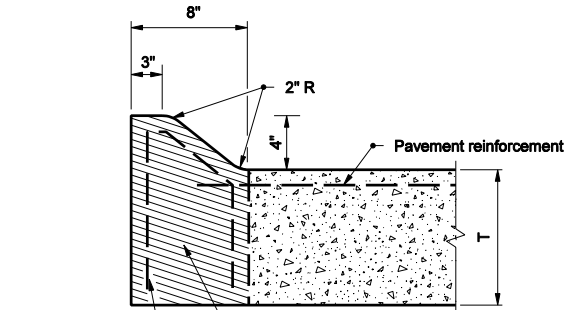

#4 stirrup bars at 2'-0 c. to c.
 Cross-hatched portion is integral concrete curb type B

**INTEGRAL CONCRETE CURB
 TYPE B
 (MOUNTABLE)**

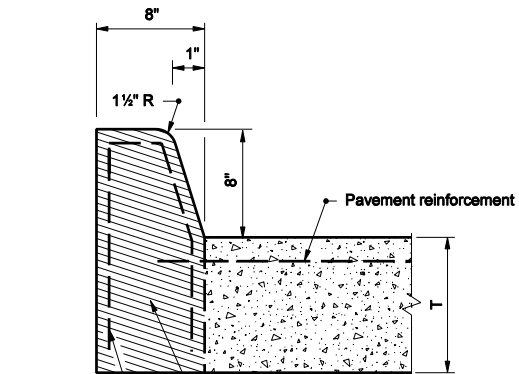

#4 stirrup bars at 2'-0 c. to c.
 Cross-hatched portion is integral concrete curb type C.

**INTEGRAL CONCRETE CURB
 TYPE C
 (BARRIER)**

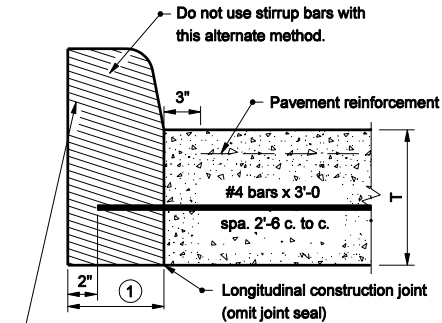

Do not use stirrup bars with this alternate method.
 Cross-hatched portion is integral concrete curb, integral concrete curb, type B, or integral concrete curb, type C.

**ALTERNATE METHOD
 OF CONSTRUCTION FOR ALL TYPES
 OF INTEGRAL CONCRETE CURB**

NOTES

- ① 8" for integral concrete curb type B or C and 7" for integral concrete curb.
- ② Concrete below this line may be poured with the pavement.

LEGEND

T = Nominal pavement thickness

INDIANA DEPARTMENT OF TRANSPORTATION	
INTEGRAL CONCRETE CURB	
SEPTEMBER 2004	
STANDARD DRAWING NO. E 605-CCIN-01	
	/s/ Richard L. VanCleave 9-01-04 DESIGN STANDARDS ENGINEER DATE
	/s/ Richard K. Smutzer 9-01-04 CHIEF HIGHWAY ENGINEER DATE
DESIGN STANDARDS ENGINEER	