

General Notes

- 1. Barricades lights, signs, and supports shall meet NCHRP 350 crash evaluation criteria.
- ② The Detour Arrow sign shall be used only when a detour route has been signed.

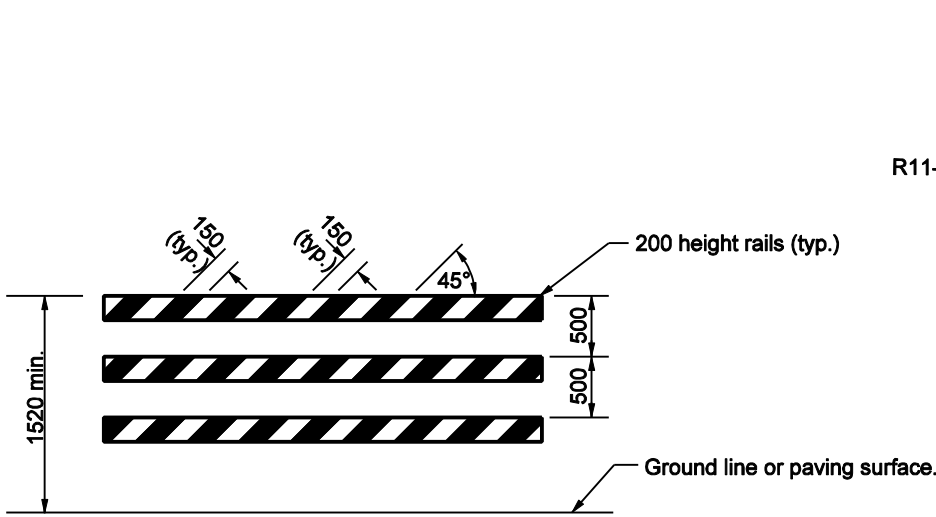

TYPE III BARRICADE

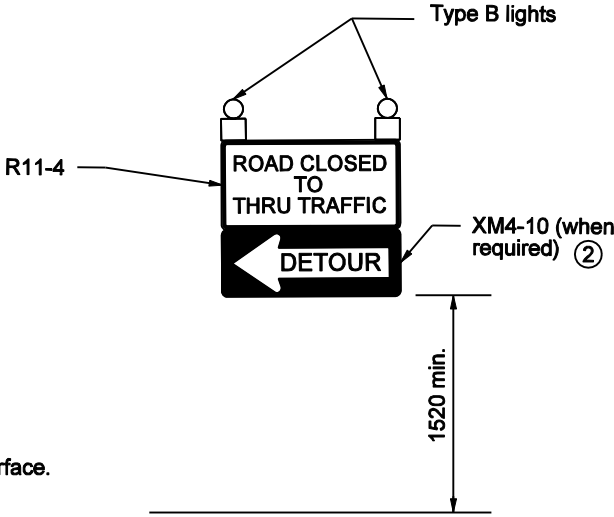

All Dimension are in mm unless otherwise specified

INDIANA DEPARTMENT OF TRANSPORTATION											
TYPE III BARRICADE											
SEPTEMBER 2002											
STANDARD DRAWING NO. 801-TCDV-04											
	<table style="width: 100%; border: none;"> <tr> <td style="border: none;"><i>/s/ Richard L. VanCleave</i></td> <td style="border: none; text-align: right;">9-03-02</td> </tr> <tr> <td style="border: none;">DESIGN STANDARDS ENGINEER</td> <td style="border: none; text-align: right;">DATE</td> </tr> <tr> <td colspan="2" style="border: none;"> </td> </tr> <tr> <td style="border: none;"><i>/s/ Richard K. Smutzer</i></td> <td style="border: none; text-align: right;">9-03-02</td> </tr> <tr> <td style="border: none;">CHIEF HIGHWAY ENGINEER</td> <td style="border: none; text-align: right;">DATE</td> </tr> </table>	<i>/s/ Richard L. VanCleave</i>	9-03-02	DESIGN STANDARDS ENGINEER	DATE			<i>/s/ Richard K. Smutzer</i>	9-03-02	CHIEF HIGHWAY ENGINEER	DATE
<i>/s/ Richard L. VanCleave</i>	9-03-02										
DESIGN STANDARDS ENGINEER	DATE										
<i>/s/ Richard K. Smutzer</i>	9-03-02										
CHIEF HIGHWAY ENGINEER	DATE										
DESIGN STANDARDS ENGINEER											