

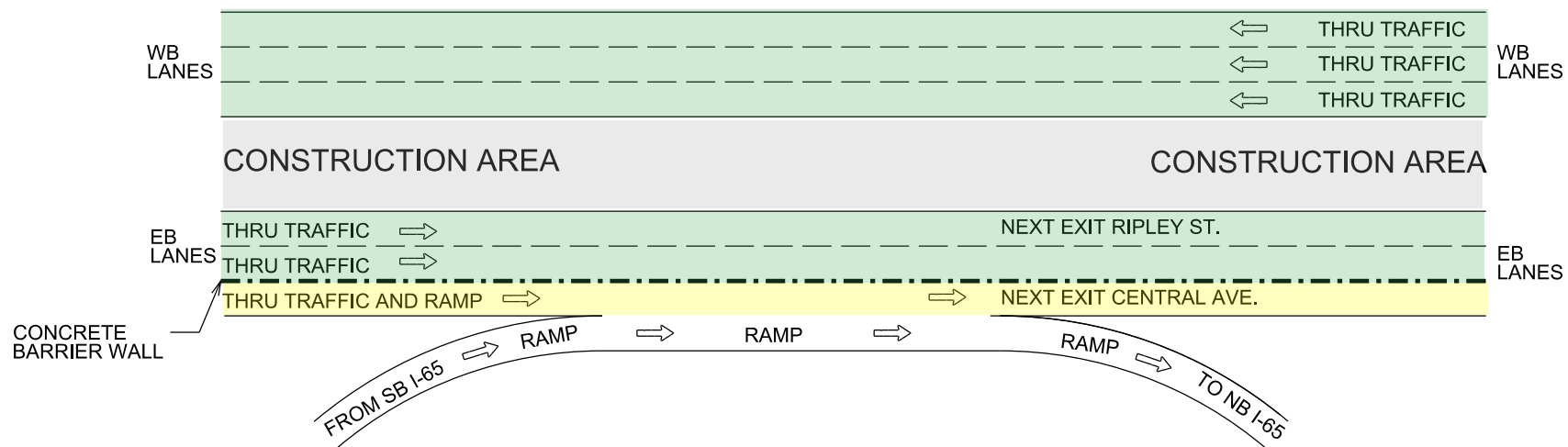

Fall 2009 - Summer 2010 Lane Configuration on I-80/94

For the Widening of I-80/94
between Broadway (S.R. 53) and Central Ave.

SPEED LIMIT 45 MPH



- RAMP
- THRU TRAFFIC
- THRU TRAFFIC AND RAMP
- CONSTRUCTION AREA

