



**2025 Budget Presentation**  
**Commission for Higher Education**  
**Purdue University President Mung Chiang**  
October 10, 2024



# *Purdue's Foundational Values*

## **Excellence at Scale With Affordability**

- 58,000 students on main campus
- 107,000 students systemwide
- Top 10 U.S. public university

**13** YEARS OF  
**FROZEN**  
**TUITION**

## **Jobs, Workforce, Innovation**

- Jobs lead to brain gain
- Workforce attracts new jobs
- Innovation co-generates jobs and workforce



## **Individual Freedom**

- Free inquiry
- Free market
- Defense of freedom



# Rise in Applications to Main Campus

RECORD

78,526 applications x 49.8% admissions rate x 29.1% yield rate = 11,388

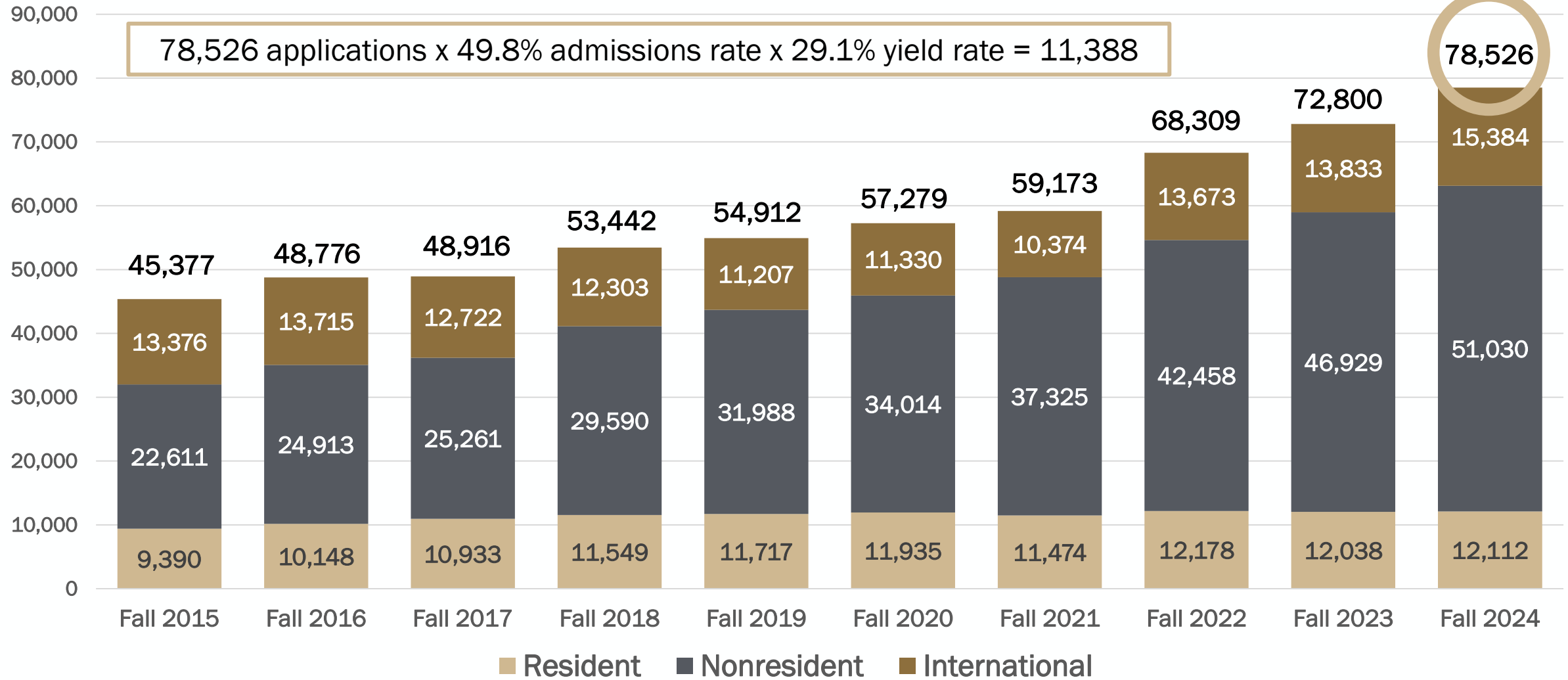

# Overall Enrollment (No Dual Enrollment)

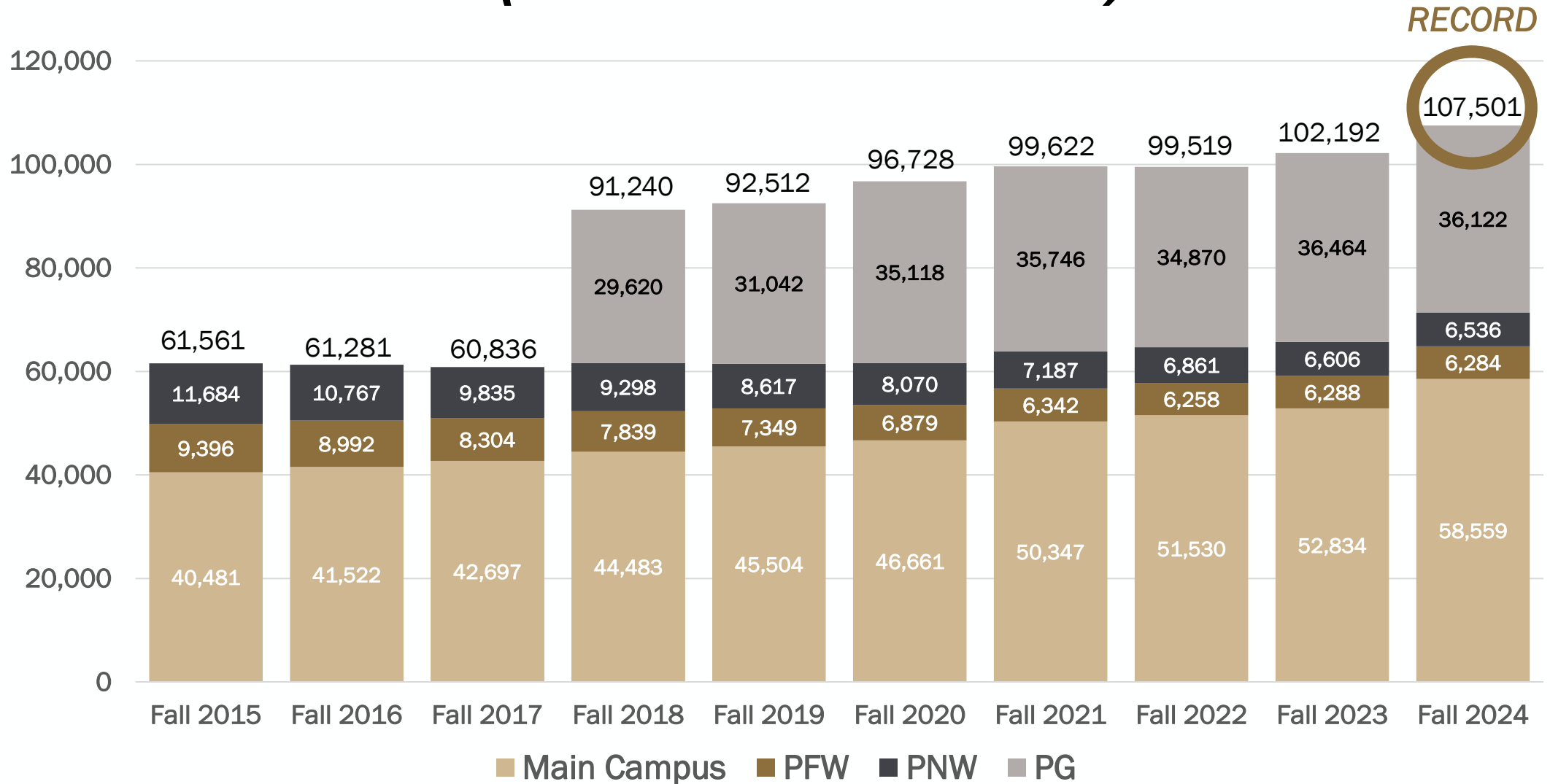

\*Purdue University in Indianapolis fall 2024 enrollment: 2,890

# *Undergraduate Hoosier Enrollment at Main Campus*

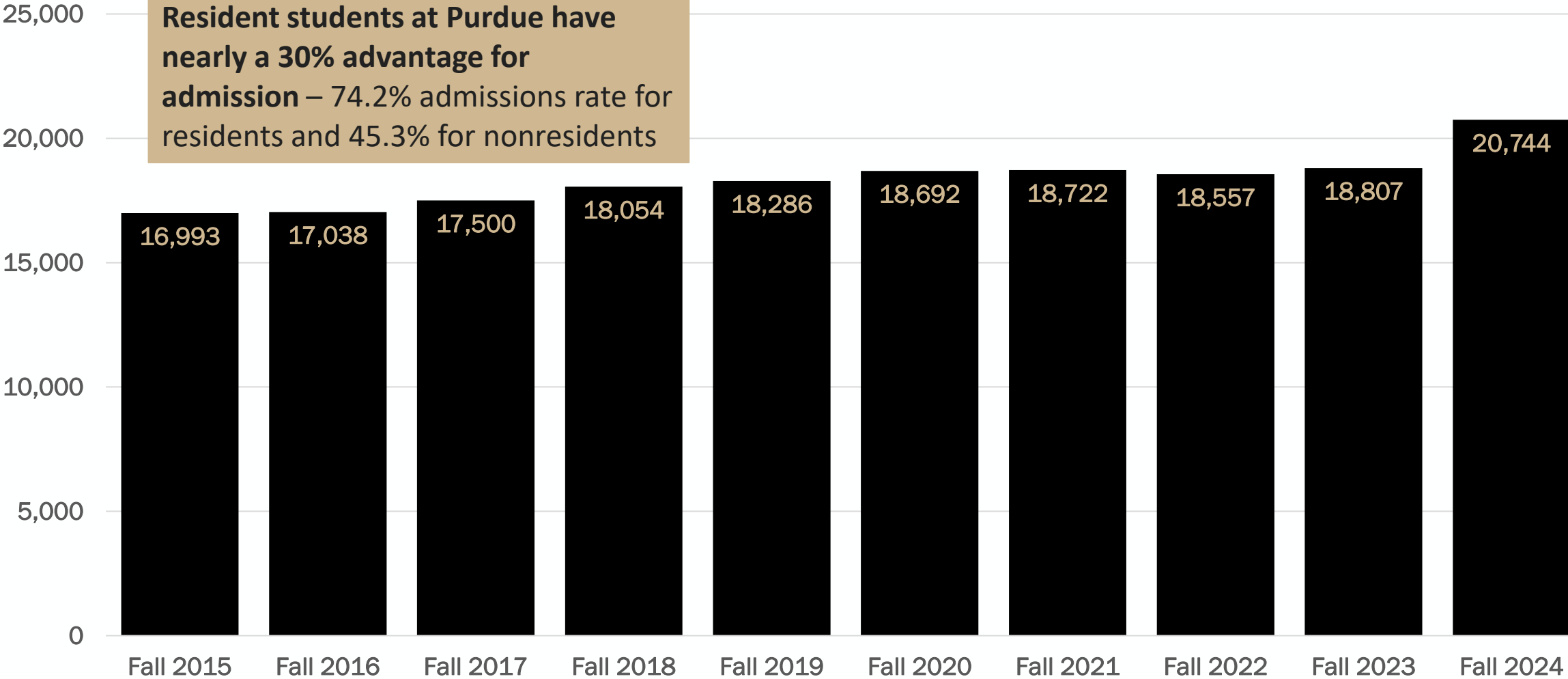

# 13 Years of Frozen Tuition

- At least **75,000 graduates & 10 graduating classes** will never experience a tuition increase.
- Today's freshmen were in first grade when Purdue last announced a tuition hike.
- Indiana residents continue to pay less than **\$10,000** per year in tuition.
- Purdue's commitment to affordability has saved its students and their families over **\$1.7B** on tuition alone since 2012-2013.

Indiana Resident Annual Tuition and Fees

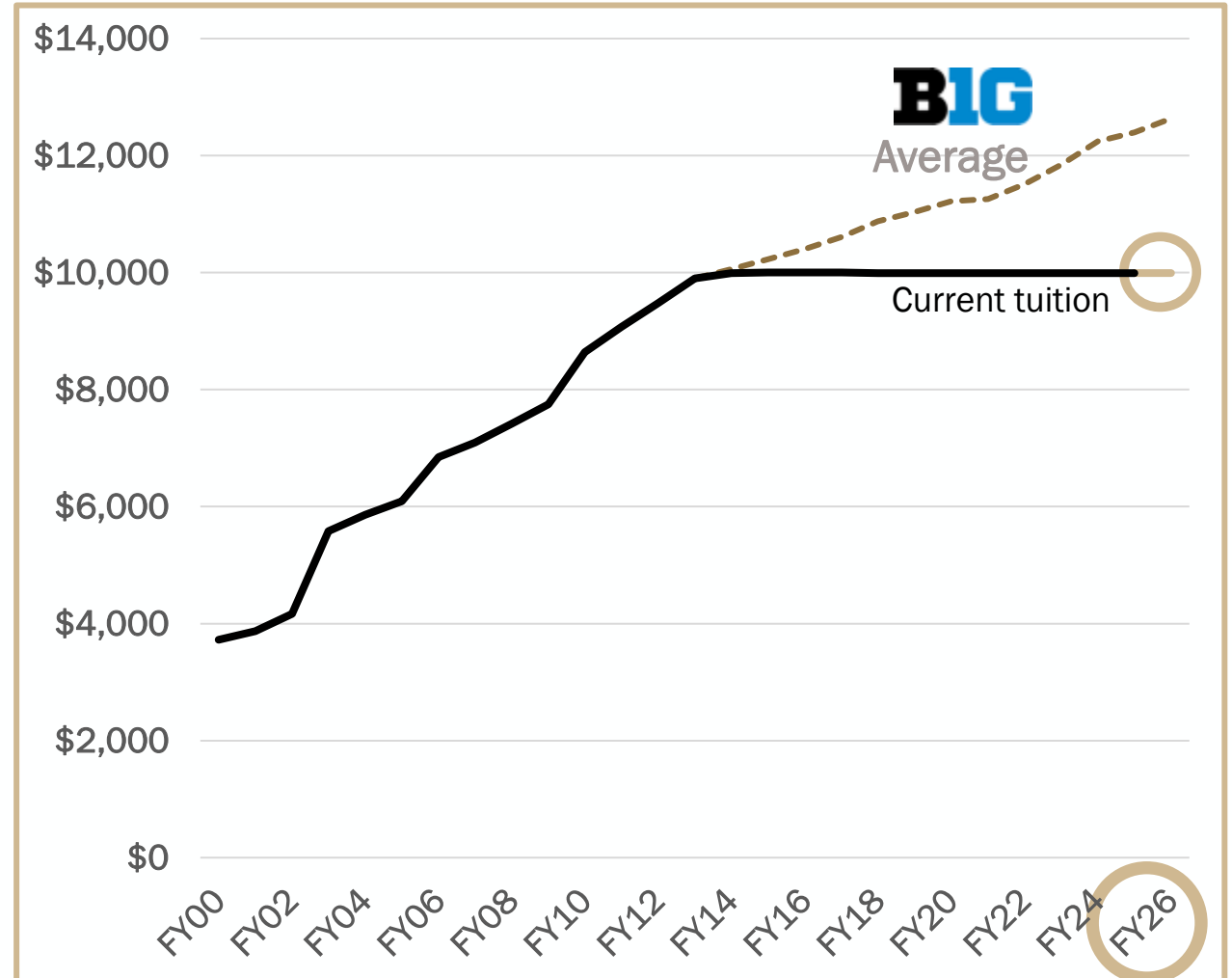

# Percent Graduating Debt Free at Main Campus

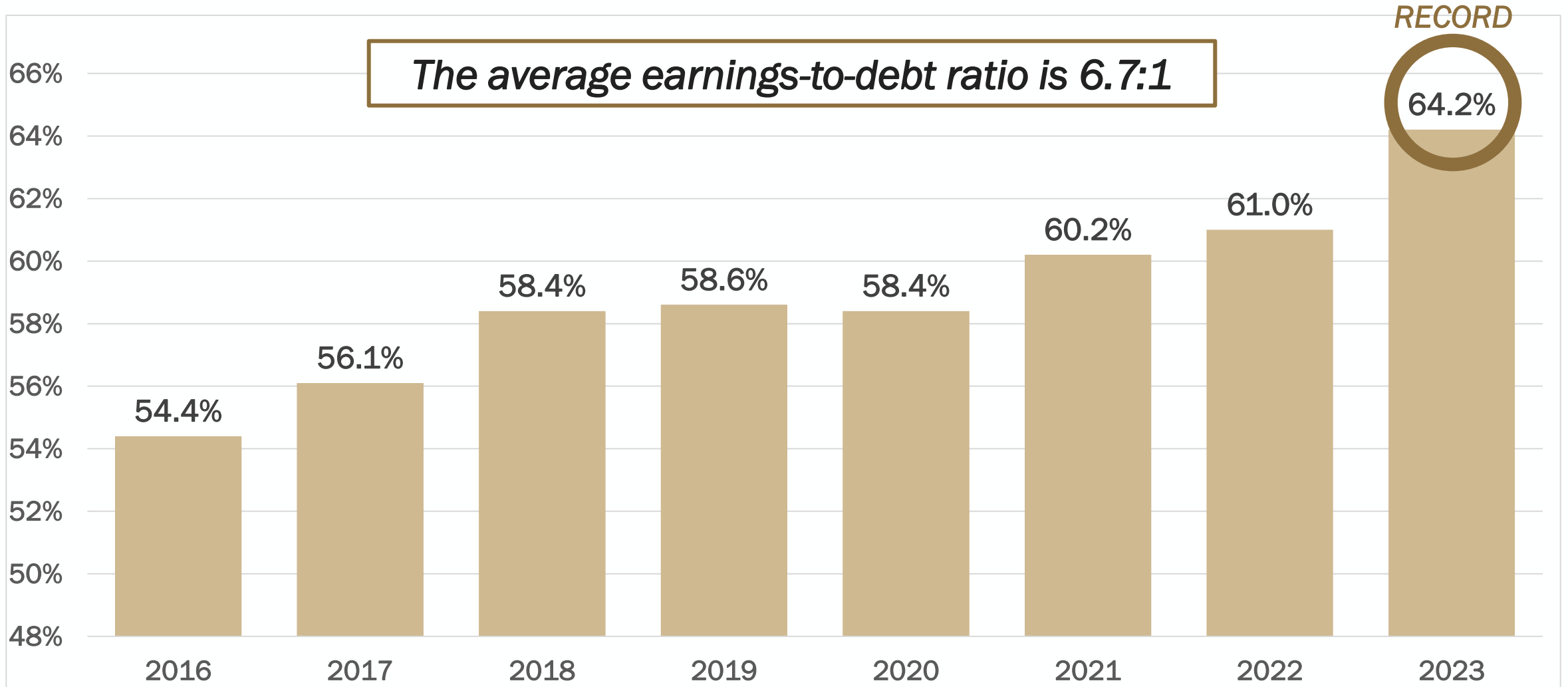

# *Lowest Average Undergraduate Time to Degree at Main Campus*

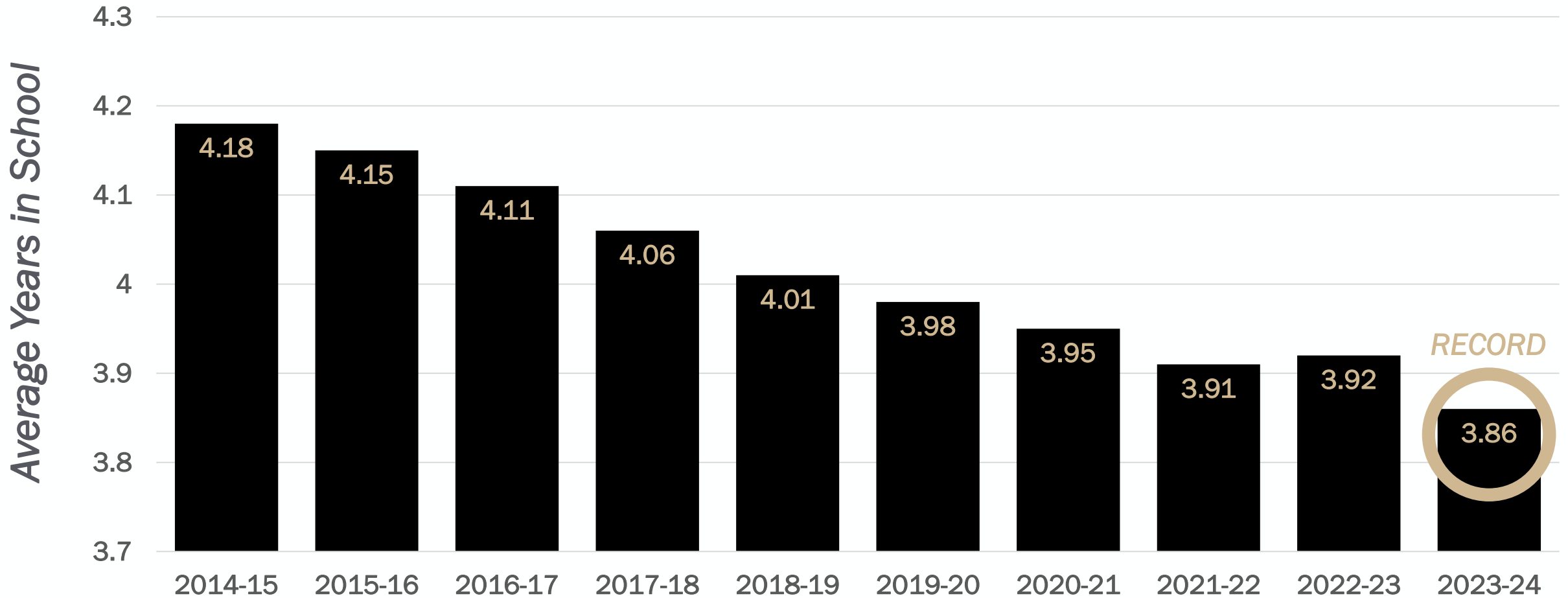



# Main Campus Graduation Rates

**New Hoosiers:** Of our graduates, 20% of out of state graduates remain in Indiana after graduation, and 36% of international students remain in the state.

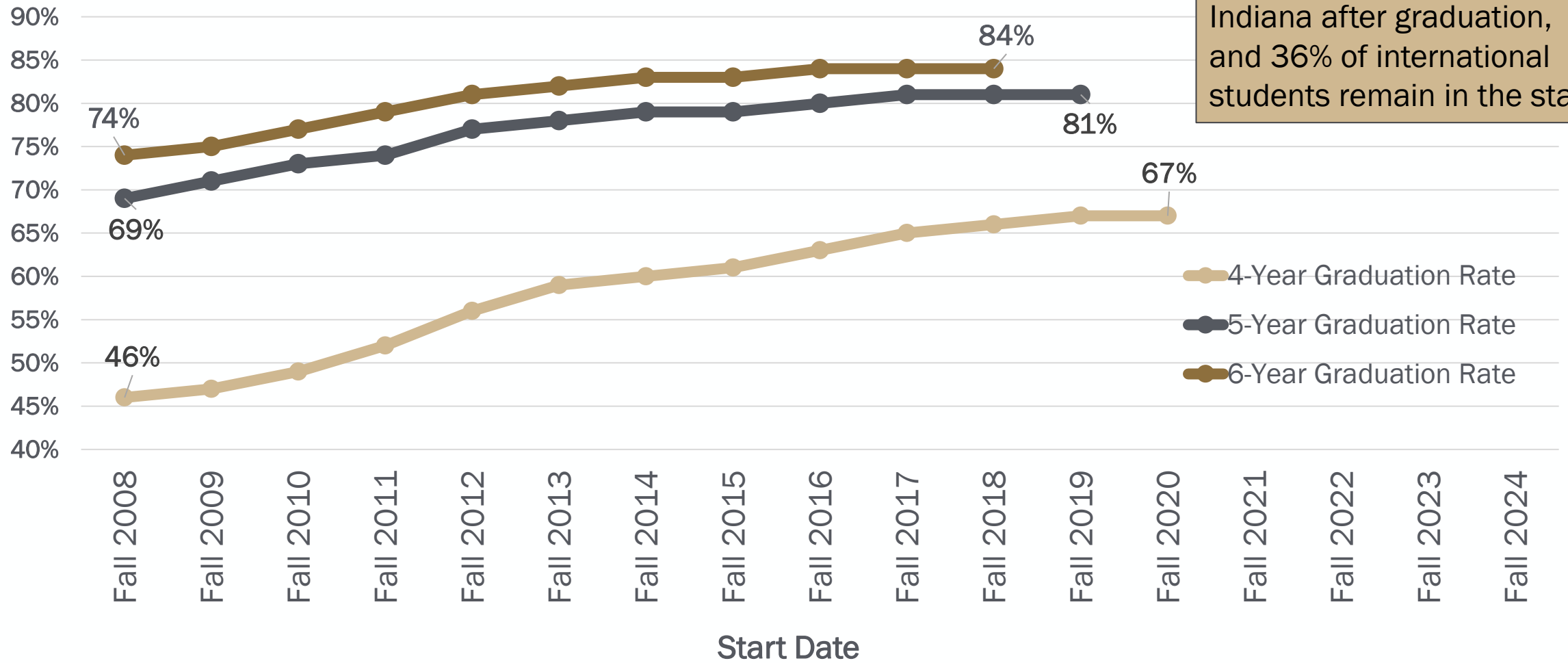

# Main Campus Percent of Undergraduate Degrees in a STEM Discipline

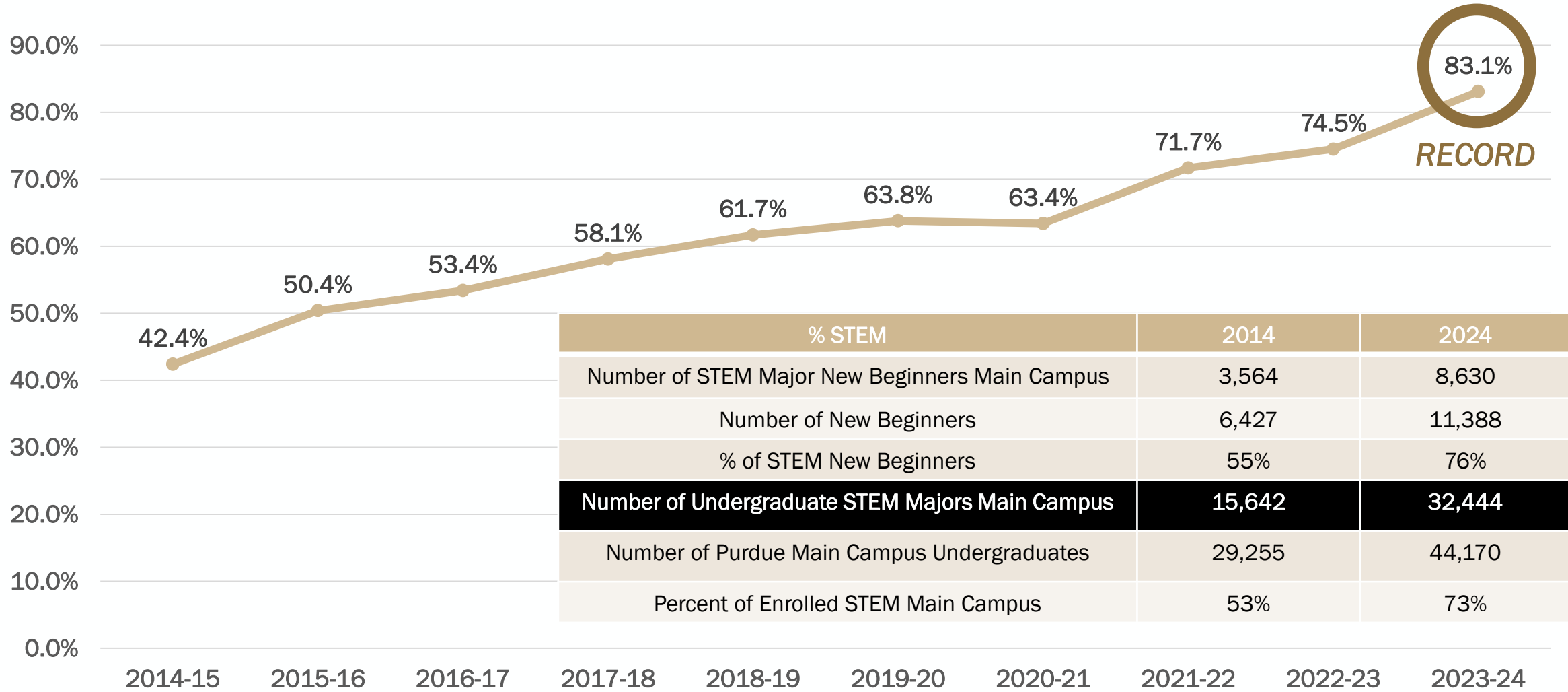

# Excellence at Scale



**#1** Most Recognized  
Public University  
IN THE U.S.  
American Caldwell, 2024



**TOP 8  
PUBLIC  
UNIVERSITY**  
IN THE U.S.  
QS World University Rankings, 2025



Purdue achieves  
**HIGHEST-EVER RANK**  
IN U.S. NEWS UNDERGRAD RANKINGS



**#4** IN THE U.S. FOR  
**PATENTS**  
Top 5 in the U.S. 3 years running  
U.S. Patent and Trademark Office, 2023



**TOP  
10**  
MOST INNOVATIVE UNIVERSITY  
IN THE U.S. - 7 YEARS RUNNING  
U.S. News & World Report, 2025



*A Brand That Matters*  
THE ONLY UNIVERSITY ON THE LIST  
**'21 '22 '23**  
Fast Company, 2023



**13 UNDERGRADUATE  
AND  
18 GRADUATE  
PROGRAMS IN THE  
TOP 10**  
U.S. News & World Report



**#1** PUBLIC  
UNIVERSITY  
IN INDIANA  
U.S. News & World Report, 2025



**INDIANA'S ONLY  
GLOBALLY RECOGNIZED  
TOP-100  
UNIVERSITY**  
Times Higher Education World University Rankings 2024 &  
QS World University Rankings 2024 & 2025



**#1**  
Public University  
for Graduating Fortune  
500 CEOs  
Strategas, 2024

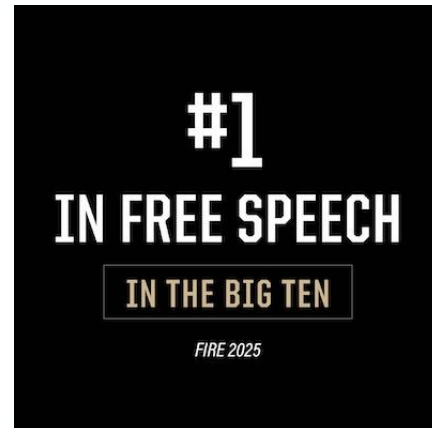

**#1**  
IN FREE SPEECH  
IN THE BIG TEN  
FIRE 2025

# Hard Tech Corridor

The Purdue University System received more than \$647 million in research funding for fiscal year 2023-24. Each year over the past decade, the university has set a new record for research awards. The total represents a 6% increase over FY23 and a 102% increase since FY 2013.

Private industry and nonprofit organizations also contributed nearly \$142 million in funding to support Purdue research.

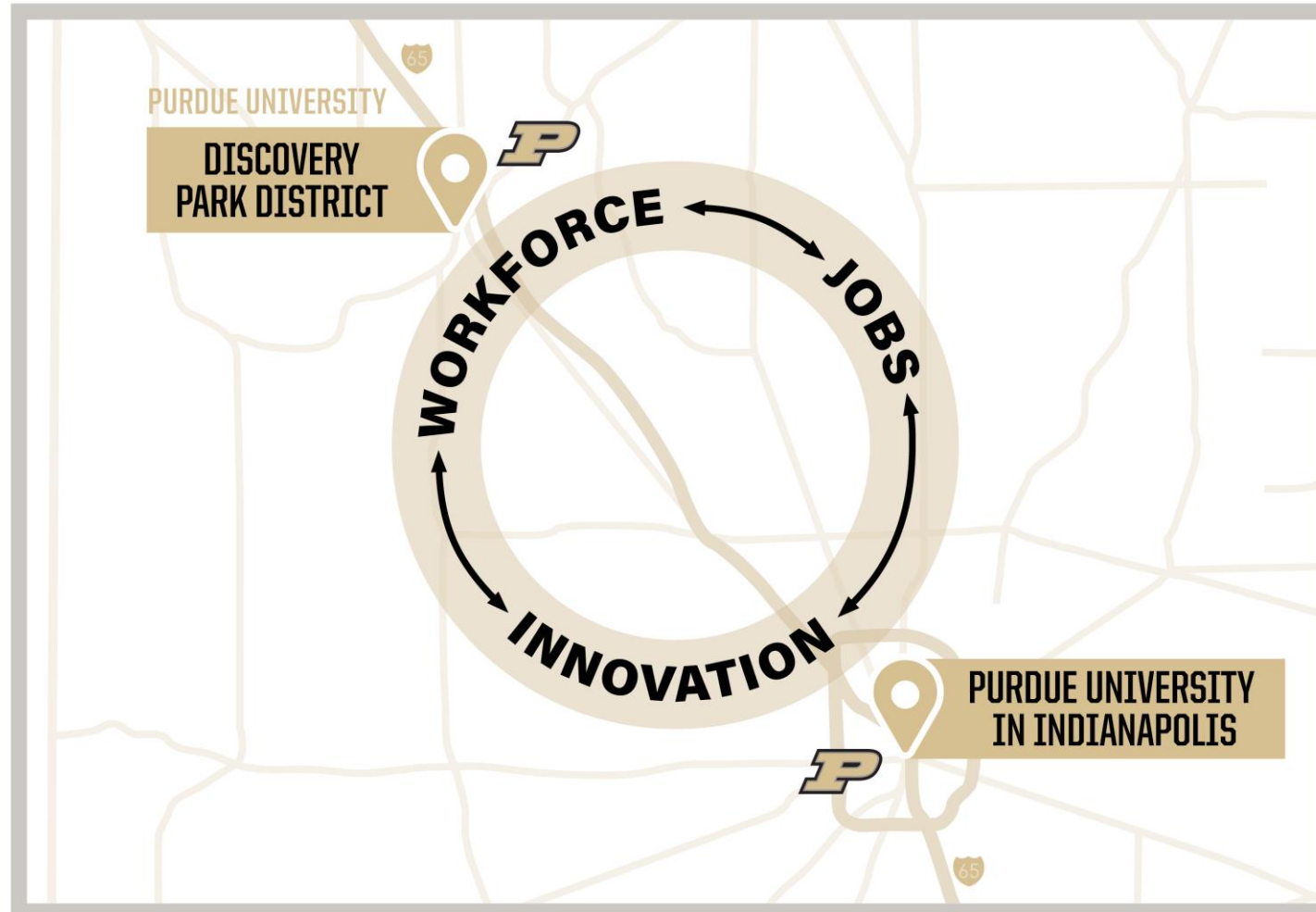



# Hard Tech Corridor Bookends



## West Lafayette



## Indianapolis

**A** Purdue Campus

**SHARED BUILDINGS WITH PURDUE PROGRAMMING**

ET	Engineering/Technology Building
SL	Engineering Science & Technology Building
LD	Science Building
EL	Science & Engineering Laboratory Building
IO	Innovation Hall
NH	North Hall

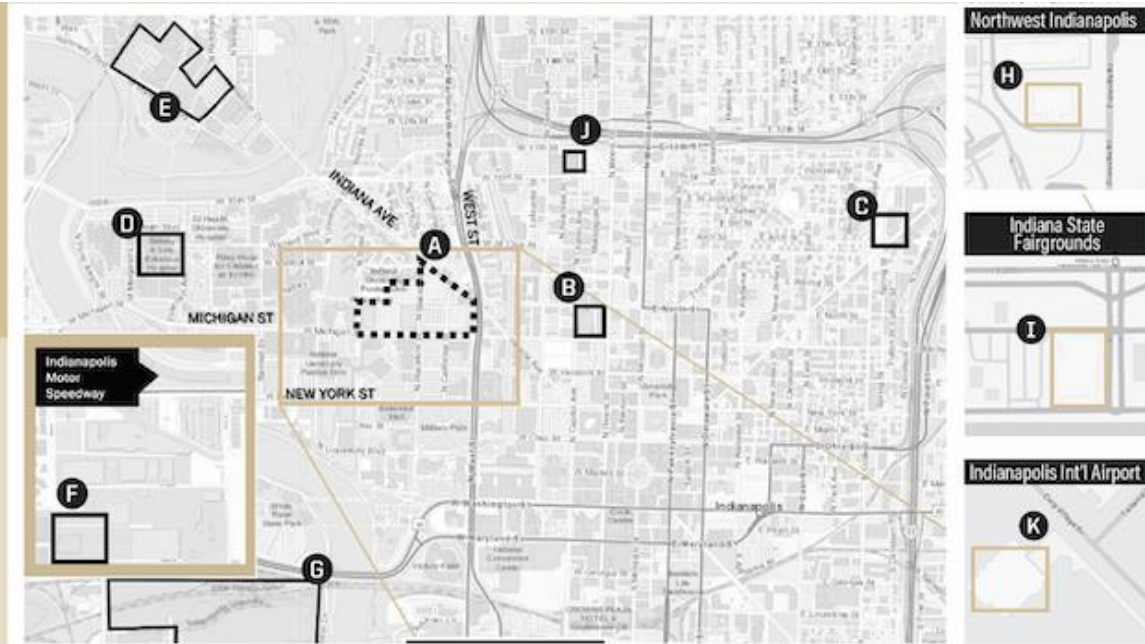

- B** LUX on Capitol
- D** Eskenazi Health
- H** SpectronRx
- C** High Alpha/Bottleworks District
- E** 16 Tech
- I** Purdue Extension
- F** Dallara
- J** Stutz
- G** Elanco
- K** Purdue Polytechnic Indianapolis



# *Purdue Wins 3 out of 3 National Hub Competitions*

As part of the Applied Research Institute team in Indiana, Purdue secured three federal hub designations in fall 2023, each with a 10% success rate:

- **Midwest Alliance for Clean Hydrogen Hub (DOE)**
  - Purdue University Northwest is the only university in Indiana to secure a hydrogen hub.
- **Silicon Crossroads Microelectronics Commons Hub (DOD)**
  - The Microelectronics Commons Hub is based on Purdue West Lafayette's strength in semiconductors.
- **Regional Technology and Innovation Heartland BioWorks Hub (DOC)**
  - The regional tech hub is in the Indianapolis metropolitan statistical area, where Purdue University in Indianapolis opened in July.



# *Strategic Initiatives – Purdue University in Indianapolis*

Purdue University in Indianapolis is a fully integrated expansion of the West Lafayette campus throughout Indiana's capital city, expanding Purdue's academic and research excellence while investing in and partnering with Indianapolis to grow the tech-driven economy across the state.

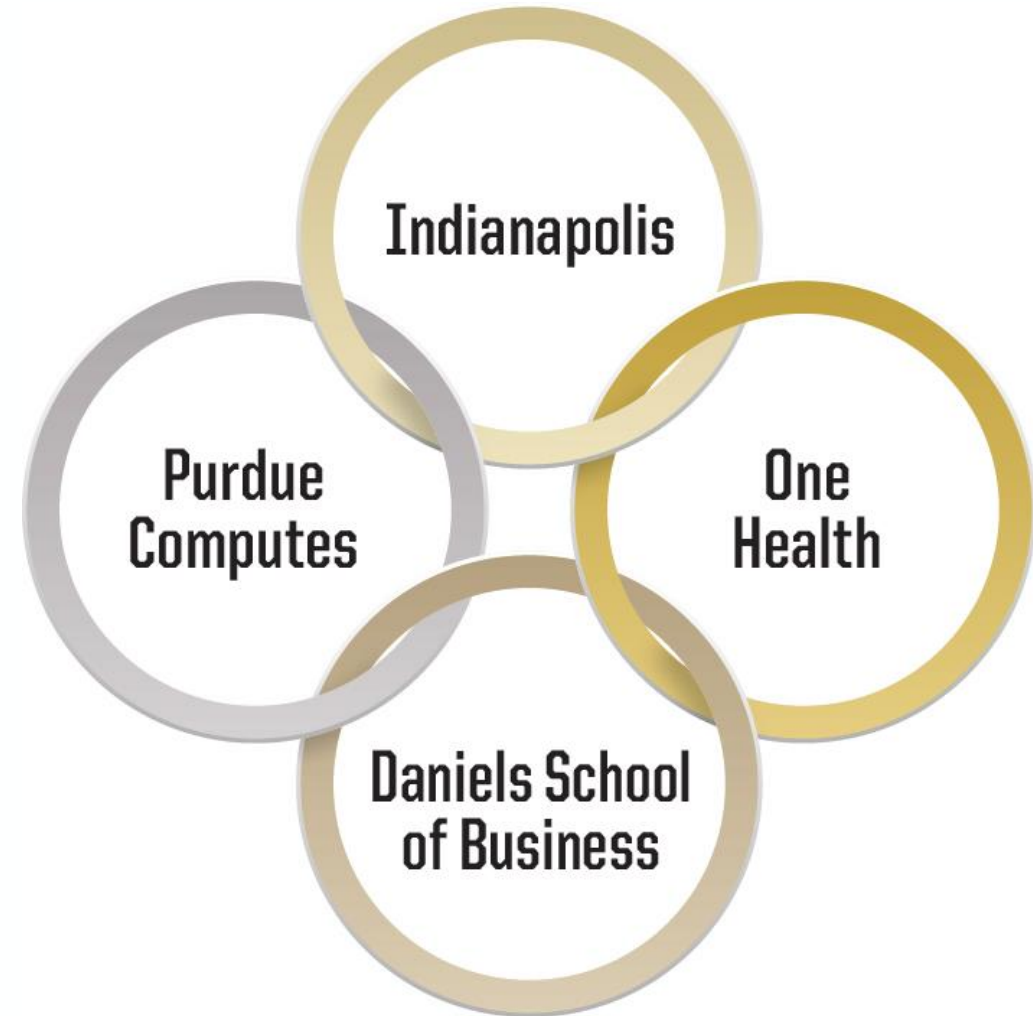

# *Strategic Initiatives – Daniels School of Business*

The Daniels School of Business aims to educate many future leaders of a technology-driven, free market economy, becoming an international leader at the intersection of business and technology in its undergraduate, graduate and executive education and in research and business partnerships.



# *Strategic Initiatives – Purdue Computes*

Purdue Computes addresses the increasing student interest in computing-related majors and the societal impact of artificial intelligence and chips through four pillars: computing education; a universitywide Institute of Physical AI; semiconductor education, research and industry partnerships; and quantum science and engineering.





# *Strategic Initiatives – One Health*

**One Health** leads critical research for animals, humans and environmental health through four impact areas: academic health affairs, the One Health Innovation District, new life sciences and chemistry-related research facilities, and an Eli Lilly and Company partnership.





# Appropriations History

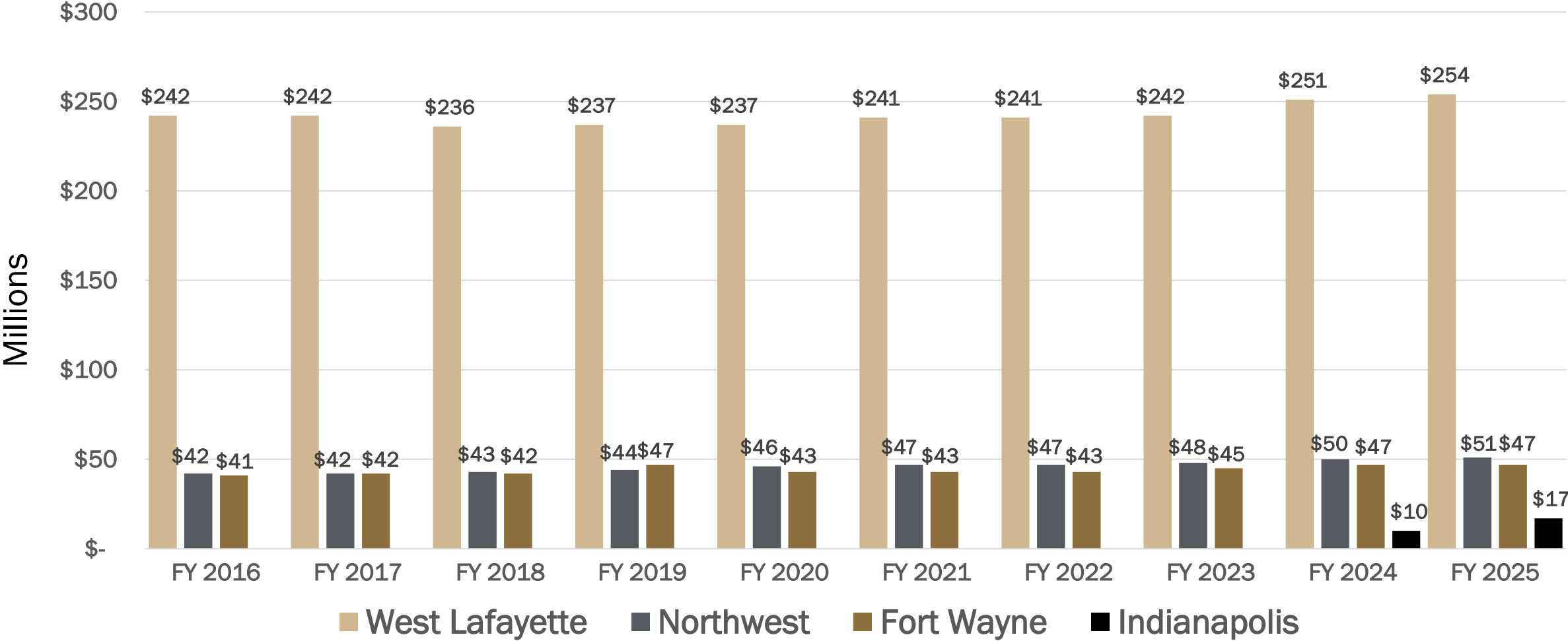

# *Line Item Appropriations*

Line Items	2025	2026	% Increase	2027	% Increase
Statewide Technology	\$6,695,258	\$6,695,258	0%	\$6,695,258	0%
County Ag Extension	\$8,000,000	\$8,000,000	0%	\$8,000,000	0%
Ag Research and Extension – Crossroads	\$9,000,000	\$9,000,000	0%	\$9,000,000	0%
Center for Paralysis Research	\$522,558	\$522,558	0%	\$522,558	0%
Indiana Technical Assistance and Advanced Manufacturing Competitiveness	\$4,430,212	\$4,430,212	0%	\$4,430,212	0%

# *Life Sciences Research Building*

## Capital Priority No. 1

- Purdue is requesting \$90,000,000 from the state and will provide \$70,000,000 in gift funds for a project total of \$160,000,000.
- The LSRB will support One Health, a comprehensive approach to advance and improve the health of Hoosier people, animals, plants and the environment.
- By integrating engineering, data science and imaging technologies, along with the Purdue Institute for Cancer Research and our strengths in biological and life sciences, we will explore the interconnectedness of all living beings to catalyze new discoveries and innovations.
- This 140,000-square-foot project will provide a new home for life science research programs in energy- and space-efficient laboratories with core support space that meets the needs of the leading-edge research being conducted — all designed to improve Hoosier health outcomes.



# *Purdue – A Leader in Securing America’s Future*

## *National Security*

*“Reshoring chip production on American soil is important for both our economy and national security.”*

*- Senator Todd Young*

## *Economic Security*

High-paying careers for PhDs to high school graduates in an industry with predicted growth for decades

Semiconductor companies have extensive supply chains bringing opportunities for small- to medium-sized Indiana businesses

## *Job Security*

According to a federal study, the semiconductor industry directly employs more than 200,000 people in the U.S., and 70,000 additional jobs are expected to be added by 2032 fueled by CHIPS Act investments and industry growth.



- First comprehensive semiconductor degree program in the U.S. launched in 2022
- One of the nation’s finest academic cleanrooms, Birk Nanotechnology Center houses advanced research and development on semiconductors
- Leading SCALE, a national network for microelectronics workforce development
- Developed STARS, a summer hands-on experiential learning for semiconductor students
- A Purdue-Ivy Tech partnership funded by READI PITCH is developing the skilled technician workforce and engaging K-12 students to develop the talent pipeline

# Purdue – Proven Success and Poised for Opportunities

**CHIPS Act R&D Programs and Facilities: \$11B**

## Key Industry Partnerships:

▪ SK hynix	▪ Crane NSWC	▪ Nanced
▪ Global Foundries	▪ Dassault Systèmes	▪ Lam Research
▪ Intel	▪ imec	▪ MediaTek

## Major Opportunities:

- CHIPS Manufacturing USA Institute
- CHIPS National Advanced Packaging Manufacturing Program (NAPMP)
- CHIPS AI-Powered Autonomous Experimentation for Sustainable Semiconductor Materials
- National Science and Technology Center (NSTC) Quick Start R&D Programs
- National Science and Technology Center (NSTC) Workforce Center of Excellence
- Commerce/National Science Foundation (NSF) Workforce Network

## Federal Funding Wins:

- Department of Defense, SCALE: \$65M
- Department of Defense, Silicon Crossroads: \$33M
- National Science Foundation FuSe2: \$5M

## CHIPS R&D State Competitors

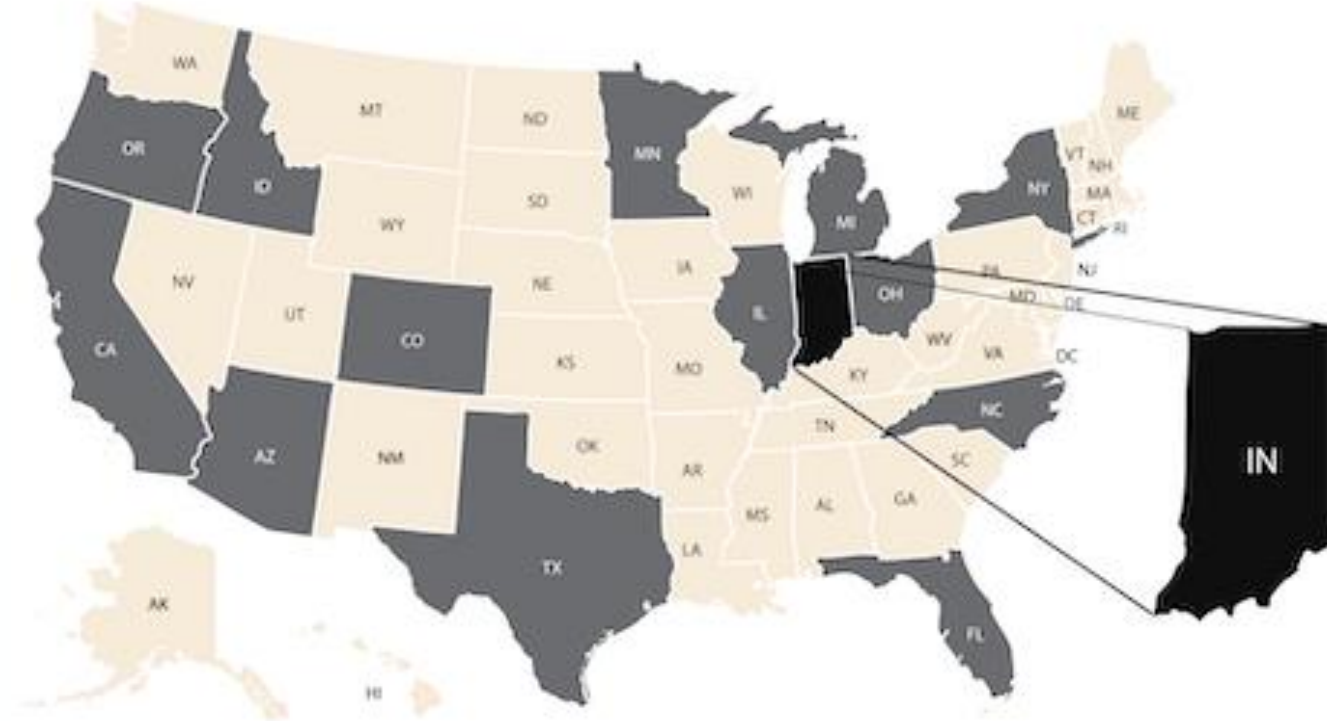



# *Appendix*

# *Line Item Appropriations – ADDL*

Line Items	2025	2026	% Increase	2027	% Increase
Animal Disease Diagnostic Laboratory (ADDL)	\$5,000,000	\$8,274,000	65%	\$6,637,000	-20%

Per IC 21-46-3-5, requests for any increases in funds for ADDL must originate from the Board of Animal Health (BOAH). For this reason, Purdue is asking that the appropriation be moved under BOAH. This would not change Purdue’s role in managing the ADDL as described in statute.

# *Notable Reputation Relative to Competitors*

Ranking	Source	Indiana Public	Big Ten	Nation
Most Innovative School	U.S. News & World Report — Best Colleges 2025	No. 1	No. 1	No. 9
Top Public National University	U.S. News & World Report — Best Colleges 2025	No. 1	No. 8 (tie)	No. 18
Best Value National University	U.S. News & World Report — Best Colleges 2025	No. 1	No. 4	No. 66
Best College for Veterans	U.S. News & World Report — Best Colleges 2025	No. 1	No. 9 (tie)	No. 25
Best Co-ops/Internships	U.S. News & World Report — Best Colleges 2025	No. 1	No. 1	No. 7
Peer Assessment Rank	U.S. News & World Report — Best Colleges 2025	No. 1	No. 7	No. 34
Portion of Graduates Earning More Than a HS Graduate	U.S. News & World Report — Best Colleges 2025	No. 1	No. 1	No. 29
Best Universities in the World	Times Higher Education World University Rankings 2024	No. 1	No. 9	No. 33
World's Best Universities	QS World University Rankings 2025	No. 1	No. 6	No. 24 (tie)
Global Academic Reputation	QS World University Rankings 2025	No. 1	No. 8	No. 26
Global Employer Reputation	QS World University Rankings 2025	No. 1	No. 3	No. 17
Top 100 U.S. Universities Granted U.S. Utility Patents	National Academy of Inventors 2023	No. 1	No. 1	No. 4
Safest College in America	Academic Influence 2024	No. 1	No. 1	No. 1

# *Purdue University Northwest Regional Impact*

- **Industrial Decarbonization** — Purdue Northwest, led by the Center for Innovation through Visualization and Simulation (CIVS), is at the forefront of regional decarbonization efforts, actively contributing to research and partnerships aimed at reducing carbon emissions across industries in NWI.
- **Hydrogen Economy** — The university is a key partner in the MachH2 Hydrogen Hub, one of seven hubs selected by the Department of Energy. This multi-institutional effort will advance the development of hydrogen technologies in the Midwest, positioning the region as a leader in clean energy innovation.
- **Roberts Impact Lab** — PNW, in partnership with organizations such as the Bloch Tech Hub and Quantum Corridor, is serving as a catalyst for regional innovation by providing a collaborative space for students, researchers and industries to work on cutting-edge technologies in fields such as advanced manufacturing, quantum computing, technology transfer and commercialization.
- Purdue Northwest has been designated as a Hispanic-Serving Institution (HSI) by the U.S. Department of Education. PNW is eligible for additional funding and grants which will be used to improve academic programs, student services and career readiness initiatives for all students.





# Purdue Northwest Union Library Building Renovations

## Phase 1 and Porter Hall Demolition – Capital Priority No. 2

- Total project cost is \$23,000,000 with PNW providing \$4,000,000 in gift funds and operating reserve funds and requesting \$19,000,000 from the state.
- Porter Hall has \$3.2M in deferred maintenance and Student Union Libraries Building (SULB) has \$10.7M in deferred maintenance. The demolition of Porter Hall and strategic renovation of SULB will reduce PNW’s deferred maintenance backlog by over \$5M and the annual operating expenses by over \$200,000/year.
- This 29,000-square-foot renovation of SULB includes labs, modern general academic classrooms and offices to replace space lost from the demo of Porter Hall.
  - The ground floor renovation will also include converting the existing campus bookstore into a multimedia center for the College of Humanities, Education and Social Sciences.
  - The second and third floors will be strategically reconfigured to construct necessary office space and classrooms.



Porter Hall

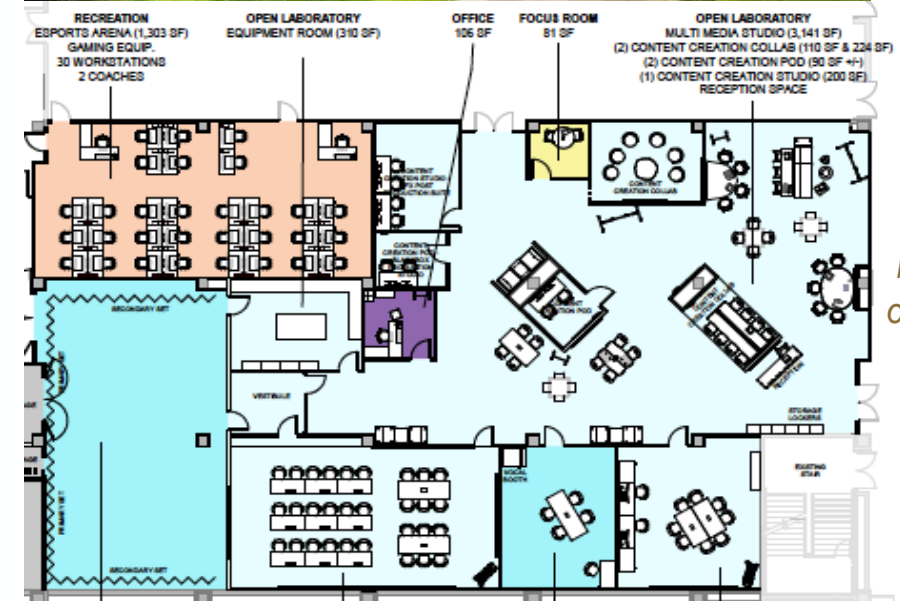

New media center plans in SULB



Rendering of new media space in SULB



# *Purdue University Northwest Enrollment (No Dual Enrollment)*

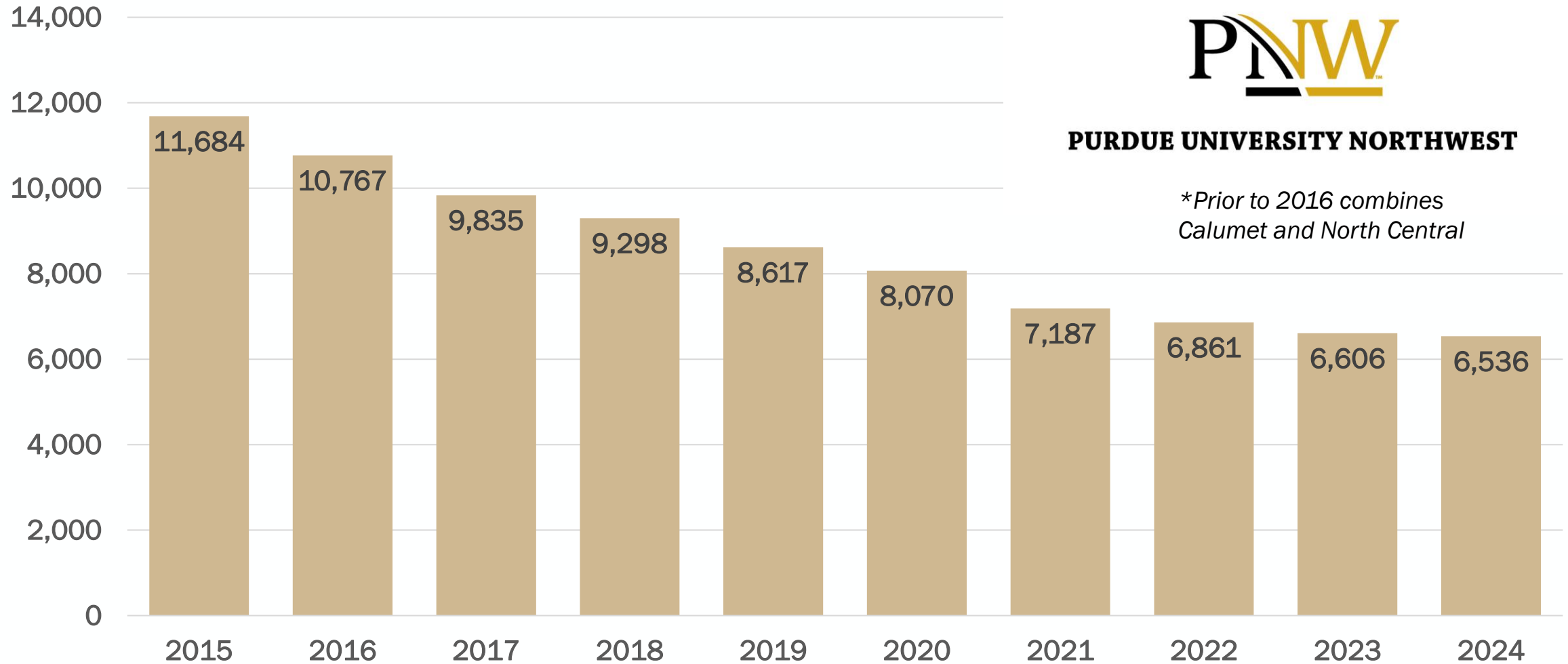

# Purdue University Fort Wayne Regional Impact

## Economic Health of the University

- The university contributes substantially to the regional and state economy. Alumni employed in Indiana generate \$11B annually statewide — \$8.9B in northeast Indiana alone. Alumni fuel more than 100,000 jobs statewide — 82,450 of those in northeast Indiana.
- PFW students graduate with less debt and lower loan default rates than the national averages — both declining at PFW the past five years. Average undergraduate debt after graduation is \$24,558 — well below the national average of \$30,500. Average loan default rate is only 2.6% compared to 8.15% nationally.
- PFW's composite financial index (CFI) has remained above 3.0 for the last three years. Compared to financial challenges at regional campuses nationally, PFW is faring considerably better than most.

## Student Enrollment and Retention

- New recruitment strategies resulted in upticks in enrollment the past two years. The university has seen a 1.2% increase in credit-hour production for fall 2024, building on a 1.2% increase for fall 2023.
- Capitalizing on its strategic focus on improving retention, PFW's fall 2024 retention rate is up 2.2%.

## Construction of Academic and Housing Facilities

- Construction is underway on the state-of-the-art Surack-Sweetwater Music Industry Building, which will accommodate rapid enrollment growth in the School of Music, create a hub of creative activity for the region and help Fort Wayne become a top 10 music city by 2031 (*opens fall 2026*).
- PFW has seen a growing demand for student housing with a waitlist for on-campus and master leased beds. Subject to state approval, the campus will be expanding its master leased beds by nearly 300, which will bring more students to the region to help fill the employee pipeline.



Rendering of Surack-Sweetwater Music Industry Building



Rendering of 600-bed student housing complex

# *Purdue University Fort Wayne Enrollment (No Dual Enrollment)*

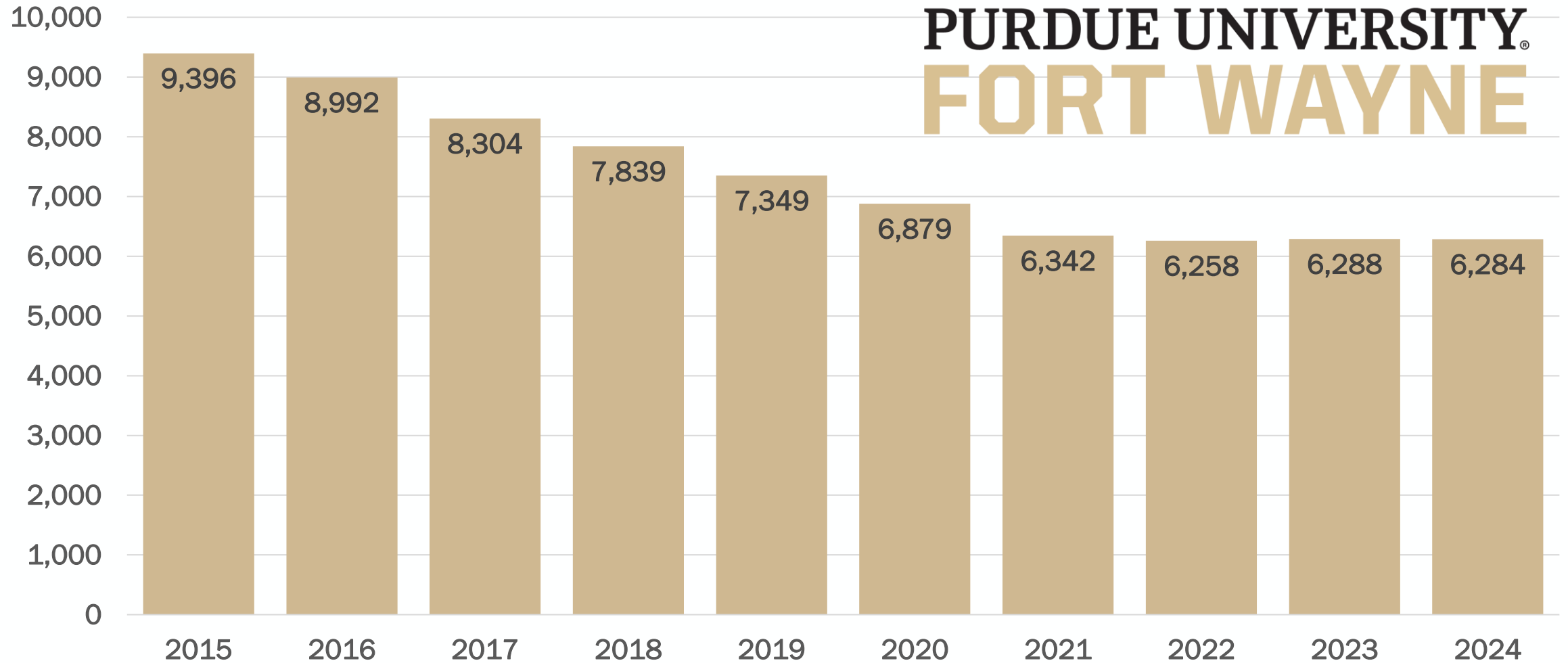

# *Outcomes Based Performance Funding in FY 2025*

Goal Met
Goal Unmet

<b>Purdue University — 85% Earned</b>
Low-Income Youth Enrollment
Adult Enrollment
On-Time Completion
Overall Completion
Low-Income Completion
Adult Completion
STEM Completion
Research
Graduate Retention

<b>Purdue Fort Wayne — 91% Earned</b>
Low-Income Youth Enrollment
Adult Enrollment
On-Time Completion
Overall Completion
Low-Income Completion
Adult Completion
STEM Completion
Graduate Retention

<b>Purdue Northwest — 60% Earned</b>
Low-Income Youth Enrollment
Adult Enrollment
On-Time Completion
Overall Completion
Low-Income Completion
Adult Completion
STEM Completion
Graduate Retention