

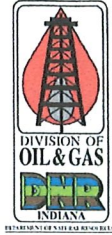

APPLICATION FOR COAL BED METHANE WELL PERMIT
 State Form 54785 (R / 8-12) / Form A15
 Approved by State Board of Accounts, 2012

INDIANA DEPARTMENT OF NATURAL RESOURCES
DIVISION OF OIL AND GAS
 402 W. Washington St., Rm. 293
 Indianapolis, IN 46204
 Telephone number: (317) 232-4055
 Fax number: (317) 232-1550
<http://www.in.gov/dnr/dnroil>



FOR STATE USE ONLY		
Application number 050935	Permit number 51948	Date received (month, day, year) 3/4/2024
Date approved (month, day, year)	Approved by <i>originally received 6/15/2022</i>	
IGS identification number 162692	IGS samples <input type="checkbox"/> Yes <input checked="" type="checkbox"/> No	IGS pool name Sandford

PART I GENERAL INFORMATION

Name of operator Keyrock Energy, LLC	Telephone number (618) 443 -8753	Fax number () -
Address of operator (number and street or PO Box) (<input type="checkbox"/> Check here if this is a new address) 207 E. Main St., Suite 2-D, PO Box 2223		
City Johnson City	State TN	ZIP code 37605
Send permit to (Enter name and address) Keyrock Energy: PO Box 2223, Johnson City, TN, 37605	Telephone number (618) 443 -8753	Fax number () -

Check here if you would like to have the permit sent via FAX or email. Email address **pharma@keyrockenergy.com**

Applicant is (Check one only) Individual Partnership Public corporation
 Limited liability company Corporation Limited partnership

NOTE: Corporations, limited partnerships and limited liability companies must register with the Secretary of State. For further information about registration, contact the Corporations Division, Secretary of State at (317) 232-6576

Type of bond (Check one only)
 Surety bond Check
 Blanket bond Personal surety bond (Valid for Non-commercial gas wells only)
 Certificate of deposit Bond not required per IC 14-37-6-1

NOTES: A bond must accompany this application unless the operator has a valid blanket bond on file with the division or is exempt from bonding under IC 14-37-6-1. All bonds must be originals and an original Verification of Certificate of Deposit form must accompany CD's. Checks must be certified. The bond amount for individual wells is \$2,500 and for blanket bonds is \$45,000.

Well type (Check one only)

Coal Bed Methane - Check the boxes below beside items that are attached to the application:
 Non-Commercial Coal Bed Methane - Check the boxes below beside items that are attached to the application:
 Form A12 – Coal Owner's and Coal Lessee's Consent Forms (Coal is leased),
 Form A14 – Coal Owner's Consent Form (Coal is not leased),
 Notices of Intent to Apply for a CBM permit and Affidavit of No Waste of Coal Resources or Miner Endangerment with Proof of Service to Coal Owner and Coal Lessee if no Consent Forms are attached (See Application Reminders),
 Notice of Intent to Survey with Proof of Service to Surface Owner (Required for every application),
 Well Stimulation Plan; OR Well will not be stimulated,
 Horizontal Drilling Plan (If applicable),
 Plugging Plan for Horizontal Well (If applicable).
 Statement of Protection of Coal for Future Underground Mining (Required for every application)

Application type (Check no more than two)

<input type="checkbox"/> New well <input type="checkbox"/> Old well workover <input type="checkbox"/> Old well deepening <input type="checkbox"/> Horizontal well sidetracking <input checked="" type="checkbox"/> Conversion <input type="checkbox"/> Change of location	<input checked="" type="checkbox"/> Change of operator (Complete PARTS I, II, VI and VII indicating lease lines and drilling unit boundaries, only unless another application type is also checked) <input type="checkbox"/> Permit renewal (Complete PARTS I, II and VI only unless another application type is also checked) Note: A \$250 permit fee is required.
--	---

Fee Payment Method: Check Credit Card (Attach credit card information on separate page or provide contact number: () -)

Former operator (If applicable)
Vessels Coal Gas, Inc

Former Permit number (If applicable)
51948

Received

JUL 23 2024

Division of Oil & Gas

PART II SURFACE LOCATION AND LEASE INFORMATION

Name of lease Ray-Carlson					Well number 1-10			Elevation (G L) 589.5	
Township 12N	Range 10W	Land type >Select One< Land number: 10	Section 10	¼ SE	¼ SE	¼ NW	Footages: 330 ft. from <input type="checkbox"/> N, <input checked="" type="checkbox"/> S, <input type="checkbox"/> NW, <input type="checkbox"/> SE line 660 ft. from <input checked="" type="checkbox"/> E, <input type="checkbox"/> W, <input type="checkbox"/> NE, <input type="checkbox"/> SW line		
County Vigo			Distance to the nearest well capable of production from the same zone in which this well will be completed: >990 feet						
Drilling unit acreage (Check one only) <input type="checkbox"/> 40 acres <input checked="" type="checkbox"/> Other _____ Exempt acres (Attach unit exception or petition for exception and supporting documentation)					*Well to be completed in Mine Void.		<input type="checkbox"/> Check here if acreage is communitized (pooled) NOTE: Attach a copy of the unit agreement or declaration of pooling. If previously submitted identify the permit number under which it was submitted: Permit No.		
Lease acreage 39.75 Acres		Does operator own or control the rights to drill and produce coal bed methane in and under all land(s) within the drilling unit boundary and the lease acreage herein indicated and shown on the attached Survey? <input checked="" type="checkbox"/> Yes <input type="checkbox"/> No If No, explain the basis upon which the operator claims the right to drill and produce coal bed methane under this permit. Describe the documents that convey the rights by type and date of execution.							
<input type="checkbox"/> Yes <input checked="" type="checkbox"/> No		Does this application include a Notice of Intent to Survey and proof of delivery to the surface owner?							

PART III PROPOSED WELL CONSTRUCTION

Check here and go to PART IV if the well presently exists and the construction will not change

Enter casing strings from largest to smallest and enter the cement information on successive rows for a casing string that will be set using multiple cement stages.

Casing Information					Cementing Information			
Casing Size (OD)	Casing Type	Casing Bottom	Casing Top	Hole Size	Cement Type	Cement Volume	Volume Type	Cement Yield
		ft.	ft.					
		ft.	ft.					
		ft.	ft.					
		ft.	ft.					

Packer setting depth _____ ft.
Packer setting depth _____ ft.
Packer setting depth _____ ft.

Centralizers at _____ ft. _____ ft. _____ ft. _____ ft.

Casing perforated From _____ ft. to _____ ft.
From _____ ft. to _____ ft.
From _____ ft. to _____ ft.
From _____ ft. to _____ ft.

PART IV DRILLING AND OPERATIONAL INFORMATION

Section a All Wells

Declination type (Check one only) Vertical Directional Horizontal **Note: For Directional & Horizontal wells the surface spot and termination point of the well must be shown on the survey.**

Proposed total vertical depth 511 feet (All wells) Proposed measured length _____ feet (Horizontal wells only)

Name of deepest formation to be drilled Coal III Seelyville

Name of deepest coal seam targeted Coal III Seelyville

Pool (Name): Sanford Or Wildcat

NAMES AND MAILING ADDRESSES OF THE SURFACE OWNER, COAL OWNER(S), COAL LESSEE(S).

Type Recipient	Name	Address	City	State	Zip code
Surface Owner	James R. Carlson	2982 Lower Sandford Road	West Terre Haute	IN	47885
Coal Owner	Charles B. Lee	1302 East Lambricht	Tampa	FL	33604
Coal Lessee	N/A				
Coal Owner	Charles B. Lee / EYRL LLC	1302 East Lambricht	Tampa	FL	33604
Coal Owner	Charles Ray Jr	1650 Darwin Rd	West Terre Haute	IN	47885

Continued on the next page

Recovered
AUG 29 2024
Division of Oil & Gas

PART V

PROPOSED WELL DIAGRAM

NOTE: This diagram is required for Coal Bed Methane wells.

WELL CONSTRUCTION

Surface casing		
Setting depth	46	feet
Size (OD)	8.62	in.
Hole size	12.25	in.
Cement top	Surface feet	
Cubic feet	50 SX	

Intermediate casing		
Setting depth		feet
Size (OD)		in.
Hole size		in.
Cement top		feet
Cubic feet		

Long string		
Setting depth	450	feet
Size (OD)	5.5	in.
Hole size	7.88	in.
Cement top	0	feet
Cubic feet	110 SX	

Liner		
Setting depth		feet
Size (OD)		in.
Hole size		in.
Cement top		feet
Cubic feet		

Centralizers		
	30	ft
	250	ft
	420	ft
		ft
		ft

Cement squeeze		
Perf. From		ft. to ft
Cubic feet		

Tubing		
Setting depth		feet
Size (OD)		in

Packers		
Setting depth		feet
Setting depth		feet
Setting depth		feet

Perforations		
From		ft. to ft
From		ft. to ft
From		ft. to ft
From		ft. to ft
From		ft. to ft
From		ft. to ft

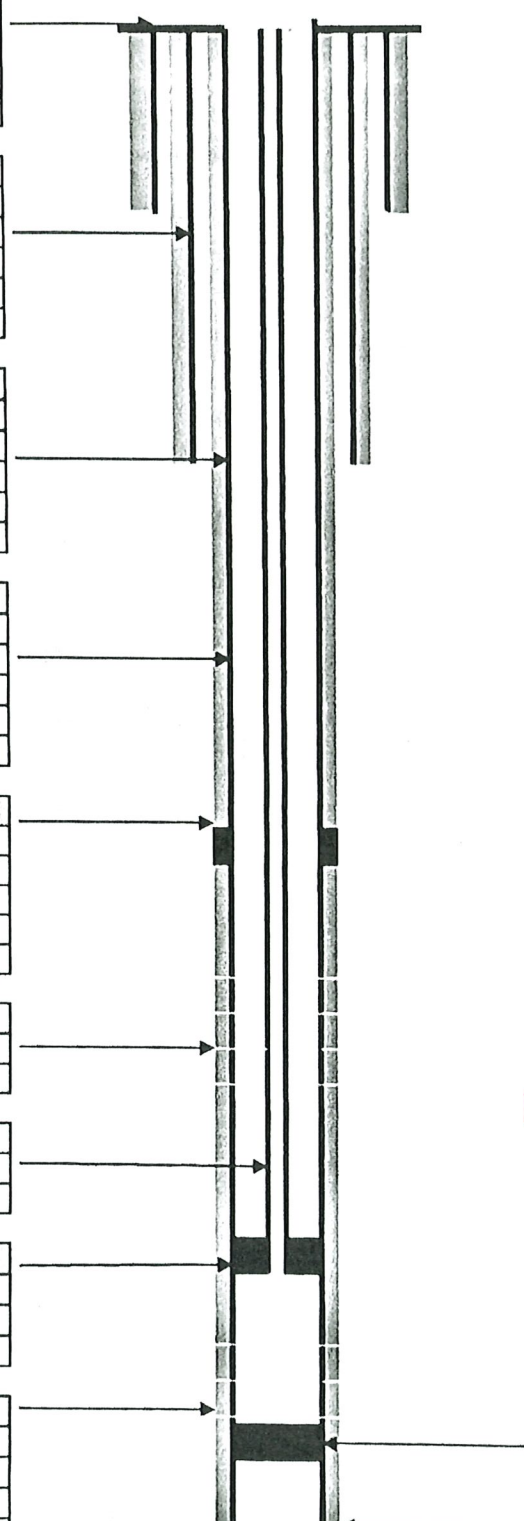

GEOLOGIC INFORMATION

Production zones (Top to bottom)		
Name	Coal III Seelyville	
Intervals From	505	to 510 ft.
Primary lithology (Check one)	<input checked="" type="checkbox"/> Coal <input type="checkbox"/> Other	
Name		
Intervals From		to ft.
Primary lithology (Check one)	<input type="checkbox"/> Coal <input type="checkbox"/> Other	
Name		
Intervals From		to ft.
Primary lithology (Check one)	<input type="checkbox"/> Coal <input type="checkbox"/> Other	
Name		
Intervals From		to ft.
Primary lithology (Check one)	<input type="checkbox"/> Sandstone <input type="checkbox"/> Limestone	
Intervals From		to ft.
Primary lithology (Check one)	<input type="checkbox"/> Coal <input type="checkbox"/> Other	
Name		
Intervals From		to ft.
Primary lithology (Check one)	<input type="checkbox"/> Coal <input type="checkbox"/> Other	

Received

AUG 29 2024

Division of Oil & Gas

Plugback depth	feet
Plugback type (Check all that apply)	
<input type="checkbox"/> CIBP	<input type="checkbox"/> Cement
<input type="checkbox"/> Other (Explain below)	

Total depth	511 feet
--------------------	-----------------

Continued on next page

#51948

PART VI AFFIRMATION	
I affirm under penalty of perjury that the information provided in this application is true to the best of my knowledge and belief.	
Typed or printed name of operator or authorized agent Bruce Horman	
Signature of operator or authorized agent 	Date signed (month, day, year) 2/8/2024

SPECIAL REQUIREMENTS

1. Incomplete applications will be returned to the operator **without** being processed.
2. **Only** those individuals whose signatures appear in PARTS V and VI of the Organizational Report may sign this form.
3. The name of the operator on this application and the name of the principal on the bond **must** be identical.
4. If you are applying for a Change of Operator permit you are certifying that you have conducted a good faith search for the current operator and said operator could not be located.
5. If you are applying for a new well permit, do not forget to include the **Notice of Intent to Survey** and proof of service required under IC 32-23-7-6.5 that must be sent to the surface owner at least five (5) days prior to entering onto the property for the purpose of surveying the well location. An example of the notice is available on the division's website under Publications/Notices and Examples.

APPLICATION REMINDERS

PART I:

- Enter the name of the operator exactly as it appears on the Organizational Report.
- If you want to have a copy of the permit certificate faxed to you please check the appropriate box.
- Don't forget to register with the Indiana Secretary of State if you will operate as a Corporation, Limited Liability Company or Limited Partnership.
- Don't forget to attach the \$250 permit fee.
- If a Certificate of Deposit is selected as the Bond Type, don't forget to attach the original CD and original Verification of Certificate form.
- Check **all** of the appropriate boxes under Well Type to indicate which attachments are being submitted with this application. Required attachments **MUST** be included with the application or it will not be processed.
- If no Coal Owner and Coal Lessee (if coal is leased) consent forms are attached and if there is no copy of a written agreement that specifies other terms of notification of the operator's intent to drill a well for coal bed methane, the operator must send a **Notice of Intent to Apply for a CBM Permit** to the Coal Owner and Coal Lessee and submit a copy of the notice along with proof of service and an Affidavit of No Waste of Coal Resources or Miner Endangerment must accompany the application. An example of the Notice of Intent is available on the division's website under Publications/Notices and Examples.
- The Horizontal Drilling Plan and Plugging Plan for Horizontal Well must be submitted only if the proposed well declination is horizontal.
- If the proposed well will be stimulated, a Well Stimulation Plan must be submitted. Otherwise, check the box indicating that the well will not be stimulated.
- The Statement of Protection of Coal for Future Underground Mining must demonstrate that commercially minable coal outside of the coal bed methane production area is adequately protected for future underground mining.
- Examples of the required notices and affidavits may be found on the division's website under Publications – Notices and Examples.

PART II

- For this proposed coal bed methane well, be sure to indicate the distance to the nearest well capable of production from the same formation for which this permit is to be issued and make sure you check the rule requirements on well spacing to avoid placing the well an insufficient distance from an existing well.
- If you check the communitized box you must attach a copy of the pooling agreement or specify the permit number for the well under which the pooling agreement was previously submitted.
- If you check the Other box under the Drilling Unit section make sure to attach a copy of the exception.
- You must indicate that you own or control all of the coal bed methane within the proposed drilling unit before a permit can be issued. If you do not own or control all of the coal bed methane within the proposed drilling unit you must describe the basis upon which you claim the right to drill and operate a well for coal bed methane production.

PART III

- This part is used by the division to determine if your proposed well construction will meet the rule requirements. Please be sure to enter all information about the proposed construction so that it can be evaluated accurately.

Received

MAR 04 2024

Division of Oil & Gas

#51948

ART IV

- For all wells, be sure to specify the proposed total vertical depth, name of the deepest formation to be drilled, lowest coal seam to be targeted and the pool name.
- For horizontal wells, be sure to specify the proposed measured length.
- Include the names and addresses of the surface owner, coal owner(s) and coal lessee(s).

PART V

- The well diagram must be completed for all Coal Bed Methane well applications.
- Indicate the proposed depths of all centralizers. Proof of cement should be submitted with the completion report and Form R12–Verification of Coal Seam Protection Report in the form of cement tickets or a cement bond log.

PART VI

- Applications that do not contain an original signature cannot be processed.
- The signature **must** match a signature shown in Parts VI or VII of the operator's Organizational Report.
- If this application is for a Change of Operator your signature in PART VI certifies that you could not obtain this permit through the permit transfer process **ONLY** because the former operator could not be located.

PART VII

- If a coal bed methane well is intended to be hydraulically fractured, on either the well survey plat or a separate map, plot the location of the proposed coal bed methane well, labeling the distances to the closest quarter-quarter section (or other land type) lines. Draw a 500 foot (or the estimated half length of the proposed hydraulic fracture plane) radius circle around the well location. Inside the circle, plot all known water wells and all oil or gas wells that are deep enough to intersect the coal seams and label the oil and gas wells with the assigned permit number.

Important: A permit issued as a result of this application is a license to conduct an activity and does not convey any property rights to the permittee. Consequently, the permittee is solely responsible for acquiring any and all property rights necessary to use the permit for its stated purpose.

Received

MAR 04 2024

Division of Oil & Gas

PART VII

SURVEY

General Instructions

Use a 1"=1000' scale

Surveyor must complete the following

- Clearly indicate the section township, and range on the survey, spot the well and show the footages from the lines
- Use the surveyor's notes to explain deviations from a standard location such as topography and irregular sections

Operator or authorized agent must complete the following

- For oil or gas wells, outline the leased or communitized area and the drilling unit allotment
- For all Directional and Horizontal wells show the termination point of the well
- For Enhanced recovery and Saltwater disposal wells, draw a 1/4 mile radius circle around the proposed well, spot all other wells (whether plugged or unplugged) that intersect the proposed injection zone(s), and put the permit number of the well over the spot.

NOTE: Please show the entire 1/4 mile radius circle around proposed Class II wells

SURVEYORS' NOTES

#1-10 RAY-

CARLSON

Elev. 589.50

N.A.V.D. 83

SURVEYORS' SEAL

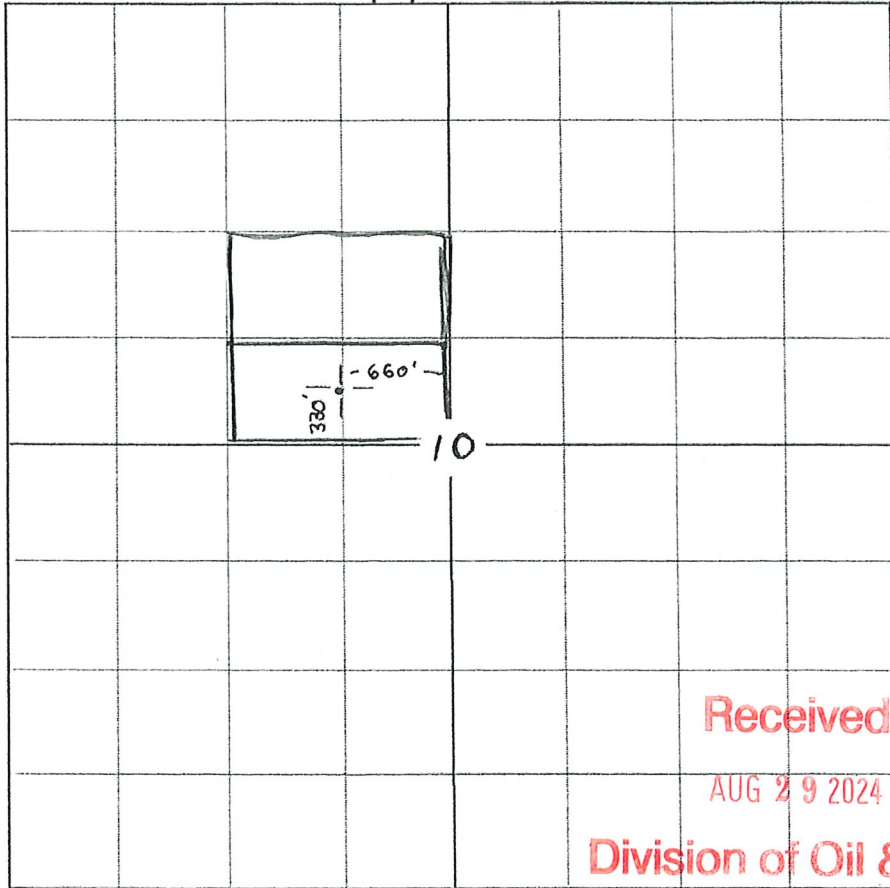

T 12 N or S

Received

AUG 29 2024

Division of Oil & Gas

R 10 E or W

CERTIFICATION

I hereby certify that to the best of my knowledge and belief, the proposed location of the above described well, fixed as the result of an instrument survey made by me in compliance with the requirements of the law of Indiana, is truly and correctly set forth hereon.

Signature of registered Indiana land surveyor

Date signed (mm,dd,yyyy)
10/2/01

Address (Street or PO, City, State, Zip)
1420 W. Co. Rd. 280 S., Greencastle, IN 46135

Telephone number
765-653-7771

Special PART VII Requirements

1. You should adjust the location of the center of the section on the diagram so that the entire set of information in the General Instructions shows on a single survey plat. (Example: If a horizontal well will begin in one section but terminate in another you should move the section center point so that portions of both sections appear on the plat)
2. This form **must** contain an original signature and original seal

Ray Carlson Well Site
Permit No. 51948
No Structures are
located within 200 feet



Received
AUG 29 2024
Division of Oil & Gas



COAL OWNER CONSENT (CBM)
(For Use When Coal is Not Leased)
 State Form 54784 (8-11) / Form A14-CNL

INDIANA DEPARTMENT OF NATURAL RESOURCES
 DIVISION OF OIL AND GAS
 402 W. Washington St., Rm. 293
 Indianapolis, IN 46204
 Telephone number: (317) 232-4055
 Fax number: (317) 232-1550
<http://www.in.gov/dnr/dnroil>

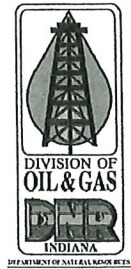

FOR STATE USE ONLY		
Date received (month, day, year)	Date approved (month, day, year)	Approved by:

PART I COAL OWNER INFORMATION			
Name of coal owner EYRL LLC - Charles Lee Manager			Telephone number () -
Address of coal owner (number and street or PO Box) 1302 East Lambright Street			
City Tampa		State FL	ZIP code 33604

PART II PROPERTY AND COAL SEAM INFORMATION			
Parcel number 84-05-10-100-006.000-021		Coal seam(s): Seelyville	Acres 39.75
Township 12N	Range 10W	Land survey type Land survey number: Section 10	County Vigo
Parcel number 84-01-33-200-001.000-025		Coal seam(s): Seelyville	Acres 80
Township 13N	Range 10W	Land survey type Land survey number: Section 33	County Vigo
Parcel number		Coal seam(s):	Acres
Township	Range	Land survey type Land survey number:	County

PART III AFFIRMATION AND SIGNATURE	
<p>I, the undersigned, affirm that I am the owner of the right to the coal on the above described parcel(s) and that I have given my consent to the extraction of the coal bed methane from said coal by ^{Keyrock}Energy LLC.</p> <p>I have not leased the coal for the purpose of coal mining and I acknowledge that the recovery of coal bed methane may result in waste of the commercially minable coal resources.</p>	
Signature of coal owner 	Date signed (month, day, year)
Name (printed or typed) Charles B. Lee	

original with #51760

Received

JUL 29 2024

Division of Oil & Gas



COAL OWNER CONSENT (CBM)
(For Use When Coal is Not Leased)
 State Form 54784 (8-11) / Form A14-CNL

INDIANA DEPARTMENT OF NATURAL RESOURCES
 DIVISION OF OIL AND GAS
 402 W. Washington St., Rm. 293
 Indianapolis, IN 46204
 Telephone number: (317) 232-4055
 Fax number: (317) 232-1550
<http://www.in.gov/dnr/dnroil>

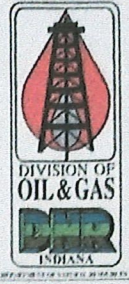

Form A14 #51948

FOR STATE USE ONLY		
Date received (month, day, year)	Date approved (month, day, year)	Approved by:

PART I COAL OWNER INFORMATION		
Name of coal owner EYRL L.L.C	Telephone number () -	
Address of coal owner (number and street or PO Box) 1302 East Lambright Street		
City Tampa	State FL	ZIP code 33604

PART II PROPERTY AND COAL SEAM INFORMATION		
Parcel number 84-05-10-100-006.000-021	Coal seam(s): Seelyville	Acres 39.75
Township 12N	Range 10W	Land survey type Land survey number: Section 10
		County Vigo
Parcel number 84-01-33-200-001.000-025	Coal seam(s): Seelyville	Acres 80
Township 13N	Range 10W	Land survey type Land survey number: Section 33
		County Vigo
Parcel number	Coal seam(s):	Acres
Township	Range	Land survey type Land survey number:
		County

PART III AFFIRMATION AND SIGNATURE	
I, the undersigned, affirm that I am the owner of the right to the coal on the above described parcel(s) and that I have given my consent to the extraction of the coal bed methane from said coal by ^{Keyrock} Energy LLC.	
I have not leased the coal for the purpose of coal mining and I acknowledge that the recovery of coal bed methane may result in waste of the commercially minable coal resources.	
Signature of coal owner <i>Charles B. Lee</i>	Date signed (month, day, year) APRIL 3, 2023
Name (printed or typed) Charles B. Lee	

Received
 MAR 04 2024
 Division of Oil & Gas



COAL OWNER CONSENT (CBM)
(For Use When Coal is Not Leased)
 State Form 54784 (8-11) / Form A14-CNL

INDIANA DEPARTMENT OF NATURAL RESOURCES
 DIVISION OF OIL AND GAS
 402 W. Washington St., Rm. 293
 Indianapolis, IN 46204
 Telephone number: (317) 232-4055
 Fax number: (317) 232-1550
<http://www.in.gov/dnr/dnroil>



FOR STATE USE ONLY		
Date received (month, day, year)	Date approved (month, day, year)	Approved by:

PART I COAL OWNER INFORMATION		
Name of coal owner Charles H Ray Jr	Telephone number () -	
Address of coal owner (number and street or PO Box) 1650 Darwin Rd.		
City West Terre Haute	State Indiana	ZIP code 47885_

PART II PROPERTY AND COAL SEAM INFORMATION			
Parcel number 84-05-10-100-006.000-021	Coal seam(s): Seelyville	Acres 39.75	
Township 12N	Range 10W	Land survey type Land survey number: Section 10	County Vigo
Parcel number 84-01-33-200-001.000-025	Coal seam(s): Seelyville	Acres 80	
Township 13N	Range 10W	Land survey type Land survey number: Section 33	County Vigo
Parcel number	Coal seam(s):	Acres	
Township	Range	Land survey type Land survey number:	County

PART III AFFIRMATION AND SIGNATURE	
<p>I, the undersigned, affirm that I am the owner of the right to the coal on the above described parcel(s) and that I have given my consent to the extraction of the coal bed methane from said coal by <small>Keyrock Energy, LLC</small>.</p> <p>I have not leased the coal for the purpose of coal mining and I acknowledge that the recovery of coal bed methane may result in waste of the commercially minable coal resources.</p>	
Signature of coal owner 	Date signed (month, day, year)
Name (printed or typed) Charles H. Ray Jr.	

Received
 JUL 29 2024
Division of Oil & Gas

#51948
NOI to Apply
for a CBM permit

NOTICE OF INTENT TO APPLY FOR A Coal Bed Methane Well Permit

Keyrock Energy, LLC, 207 E. Main St., PO Box 2223, Johnson City, TN 37605, intends to submit to the Division of Oil and Gas an application for a permit to drill and construct a well to be used for the production of Coal Bed Methane. The well will be located 330 feet from the S line, 660 feet from the E line, SE quarter, NW quarter, in Section 10, Twp. 12N, Rng. 10W, Vigo County, Indiana.

The subject well, Ray Carlson #1-10, is intended to produce coal bed methane from the Seelyville Coal Seam at an approximate depth of 505 feet.

Written comments and objections to the issuance of a permit for this well based on the premise that the well will result in waste of a commercially minable coal or that the well will endanger the health and safety of miners must be submitted to the Division of Oil and Gas within thirty (30) days of the receipt of this notice and should be mailed to:

Division of Oil and Gas
Department of Natural Resources
Attn: Technical Services Section
402 W. Washington Street, Rm. W293
Indianapolis, IN 46204-2748

After the application is submitted, you may obtain a copy of or further information about the application by contacting the division at (317) 232-4055. The submitted application will be made available for review at the above address from 8 A.M. to 4:30 A.M. EST, Monday through Friday, or on the division's website at: www.in.gov/dnr/dnroil.

Optional: I acknowledge that I have received this notice of intent to apply for a coal bed methane well permit.

Print Name

Signature

Date

Address

City, IN Zipcode

Received
MAR 04 2024
Division of Oil & Gas

#51948

Affidavit

AFFIDAVIT

In accordance with IC 14-37-4-8.5(d), Keyrock Energy, LLC, 207 E. Main St., PO Box 2223, Johnson City, TN 37605, hereby certifies that the proposed well – Ray Carlson #1-10– located in Section 10, Twp. 12N, Rng. 10W, Vigo County, Indiana is intended to produce coal bed methane from the Seelyville coal which has an average thickness of five feet at an approximate depth of 505 feet. The proposed well is located approximately within the original permitted boundary of the Green Valley Coal Mine, an existing, abandoned, and reclaimed, underground coal mine operation. The owner of the coal, EYRL, LLC, does not have experience in the underground mining of coal. The existing well was previously used for Coal Bed Methane Production. No horizontal drilling, no acidizing, and no fracturing of any kind will take place at the Ray Carlson #1-10 well. Keyrock Energy, LLC hereby states that this existing well enters the works of an abandoned coal mine. There are no miners underground, and no possibility of miners going underground. The coal was extracted via room and pillar mining, thus Keyrock Energy’s activities will have no impact on the commercially minable coal resource.

This affidavit accompanies the notice of intent to apply for a Coal Bed Methane Well Permit.

For Keyrock Energy, LLC:

Morgan Pate
Print Name
[Signature]
Signature

9/9/2022
Date

Received
APR 01 2024
Division of Oil & Gas

STATEMENT OF PROTECTION OF COAL FOR FUTURE UNDERGROUND MINING

In accordance with IC 14-37-4-8(d)(4), Keyrock Energy LLC declares that commercially minable coal outside of the coal bed methane production area that contains the proposed coal bed methane well, Ray Carlson #1-10, is protected for future underground mining for the following reasons:

- ✓ No hydraulic fracturing will be performed on the Seelyville coal that will be used for coal bed methane production.
- ✓ The proposed well is at least 500 feet (or the estimated or calculated fracture half length) inside of the outside boundary of the coal bed methane production area.
- ✓ The proposed well is not being drilled horizontally within the coal seam.
- ✓ Other: The Seelyville Coal has already been removed as a minable resource. No actions on behalf of Keyrock Energy will physically alter the remaining portions of the Seelyville Coal Seam

JOE LANE

Print Name

Joe Lane

Signature

9-28-2024

Date

Received
SEP 05 2024
Division of Oil & Gas

KEYROCK ENERGY LLC

August 27, 2024

Via Email: ARosales@dnr.IN.gov
Indiana Department of Natural Resources
Division of Oil & Gas
Attn: Alicia M. Rosales
402 West Washington St., Room 293
Indianapolis, IN 46204

Re: Ray Carlson Well Vigo County, IN

Dear Ms. Rosales:

This letter supplements Keyrock Energy's Application for Coal Bed Methane Well Permit.

Our objective is to drill and complete the well as outlined in the application to access methane in the mine void, after accessing testing of the gas flow and quality will take place. The review of these results will help guide us in its use. The gas volume, purity and economic feasibility will guide us as to whether it can be sold into the pipeline, used to make electricity, or flared.

The gas will be monitored through our metering instrumentation unit, tracking flow and composition. Also, A PLC based SCADA system will give us 24/7 monitoring capabilities, connected to a call center that will alert our staff 24/7 if any issues arise. For security and safety, a 24-hour live view surveillance camera system will also be present to monitor the site.

This gives us the information needed to pay the mineral owner their royalty and the State of Indiana severance tax. Allowing the current stranded gas in the mine void to be commercialized, so no waste of Indiana's natural resources will take place.

Respectfully,

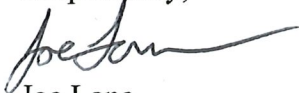

Joe Lane

Permitting Compliance Mgr.
Keyrock Energy, LLC
207 E Main St., Suite 2-D
Johnson City, TN 37604

Received

SEP 05 2024

Division of Oil & Gas

