

INDIANA DEPARTMENT OF NATURAL RESOURCES  
DIVISION OF STATE PARKS

2024 STATE PARK DEER MANAGEMENT HUNT INFORMATION SHEET



Indiana Department  
of Natural Resources

Ouabache State Park  
260-824-0926

THIS IS A FIREARMS ONLY HUNT

**Please print a copy of this document for your reference. You are responsible for understanding all the following information.**

Important Note

We appreciate your willingness to help manage the impact from deer browsing. For this management hunt to be effective, please harvest any deer that presents a safe and ethical shot (within established bag limits), especially those that are antlerless. Please make every effort to be present during the management hunt. The number of hunters allowed at each park is strategically calculated. Your absence affects how successfully we reach our objective of a balanced ecosystem. Our #1 concern during this hunt is safety. With this in mind, the following information and rules apply:

- General: All Indiana DNR Property Rules and Indiana Hunting Regulations will be enforced. Hunters are permitted to harvest deer only. No other animals may be taken during the management hunt. Friends and family will not be permitted to wait for hunters on the property during the hunt periods.
- Date & Time: The 2024 deer management hunts will be conducted on November 18<sup>th</sup> & 19<sup>th</sup> and on December 2<sup>nd</sup> & 3<sup>rd</sup>. The park will be closed to the general public from 8 p.m. ET (7 p.m., CT) on Sunday, November 17<sup>th</sup> through 8 a.m. ET (7 a.m. CT) on Wednesday, November 20<sup>th</sup> and 8 p.m. on Sunday, December 1<sup>st</sup> through 8 a.m. ET (7 a.m. CT) Wednesday, December 4<sup>th</sup>. ALL HUNTERS WILL NEED A PHOTO ID TO ENTER AND EXIT THE PROPERTY.
- Hunt Hours: Hunting hours are ½ hour before sunrise until 4 p.m. ET (3 p.m. CT) on the days of the hunt. Hunters may enter the field no earlier than 5 a.m. ET. Hunters must exit the park by 5 p.m. ET.
- Open House: No open house will be held. If you have questions concerning the hunt, please call the park office at 260-824-0926.

- Hunter Sign-In:** Hunter check-in will be at the entrance gate of the park, starting at 5 a.m. on each day of the hunts. A photo ID and hunting license will need to be shown to enter the property.
- Bag Limit:** During each hunt period for which you have been drawn you are allowed to take up to three deer, only one of which can be antlered. These deer do not count against your regular state deer hunting license or bag limit. Please do not pass on antlerless deer for deer with antlers.
- Firearms:** All firearms that may be legally used to hunt deer on public land in Indiana (as seen in the 2024-2025 Indiana Hunting & Trapping Guide) will be allowed. Archery equipment, including the use of crossbows, will NOT be permitted for these hunts.
- Check Station:** All deer must be transported to the check station in the designated location on the property for biological data collection prior to leaving the property. You will be asked the sex of the deer and whether it is antlered or antlerless. Legal check-in is the responsibility of the hunter and is described below. The check station is located at the entrance gate.
- Deer Check-In:** Hunters who successfully harvest a deer at state park deer management hunts must bring the deer to the designated location on the property for biological information to be recorded. The deer must have a temporary transportation tag completed and attached immediately upon harvest. Temporary transportation tags are provided below. The deer must also be checked-in through the online check-in system. Staff at parks are only keeping tallies of harvested deer, not checking them in. It is the hunter's responsibility to complete the legal check-in.

Deer can be checked in 3 ways:

- Online CheckIN Game System:  
<https://secure.in.gov/apps/dnr/portal/#/checkin/customer-information>
- Traditional check stations: <https://www.in.gov/dnr/fish-and-wildlife/hunting-and-trapping/hunting-trapping-guide/hunting-check-stations/>
- Phone-in option at 1-800-419-1326, however there will be a \$3 charge for this service (Visa or Mastercard only).

For general instructions on using the CheckIN Game system, visit this link:[https://www.in.gov/dnr/fishwild/files/fw-CheckIN\\_Game\\_how\\_to.pdf](https://www.in.gov/dnr/fishwild/files/fw-CheckIN_Game_how_to.pdf)

To check-in state park deer management harvests, use the following information:

- For county of harvest, please note that some properties span multiple counties

- You must select “Public – State” when asked for land type
- Select the appropriate property
- For license type, choose either “Early State Park Reduction” or “Late State Park Reduction.” Do not choose “Deer Reduction Zone.” The early management hunt is November 18 & 19, and the late management hunt is December 2 & 3; choose accordingly.

After submitting your information, you will be given a Confirmation Number that must be recorded on your temporary transportation tag and kept on the carcass until processing.

- Accessibility:** If you have special needs, you should call the property office before November 14, 2024, for the first hunt and before November 28, 2024, for the second hunt, so we can try to accommodate you. If desired, drawn hunters who possess a person with disabilities hunting permit may bring a non-hunting individual at least eighteen (18) years of age by November 18, 2024, to assist them.
- Tree Stands:** Non-penetrating tree stands may be put up by those drawn for the hunts. Steps must also be non-penetrating. A safety harness is highly recommended. Any stand left overnight in the park must have owners name, address, and phone number attached to the stand in some manner. We strongly suggest you place a lock on your stand. The park does not provide security for tree stands and is not responsible for missing or damaged stands. Stands may be put up after November 3 for the first hunt and after November 17 for the second. Stands must be removed within 48 hours of the end of each hunt.
- Ribbon/Flagging:** Flagging tape/ribbon to mark the route to your stand is permitted but must be completely removed when your stand is removed.
- Ground Blinds:** Ground blinds will not be allowed for these management hunts.
- Non-Hunters:** If you encounter any non-hunters, other than those accompanying drawn hunters, please contact property personnel and they will handle it.
- Hunter Orange:** Hunters must wear both a solid hunter orange head covering (hat or cap) AND a solid hunter orange outer garment, such as vest, coat, or coveralls, during the time they are hunting in the park. This gear should be worn at all times.
- Lodging:** No camping will be allowed during the hunts.
- Alcoholic Beverages:** Absolutely NO ALCOHOLIC BEVERAGES shall be possessed or consumed in the park or during the hunt.

- Scouting:** Pre-hunt scouting will be allowed and is encouraged. All normal park fees apply. Park only in designated areas when scouting, do not park along roadsides. Trail cameras may not be used for the management hunts.
- Safety Zones:** Safety zones have been established and you may not enter these areas except to retrieve a deer. Loaded firearms are not permitted in safety zones, buildings, or service areas. Do not shoot toward the safety zones if you are hunting near the boundaries. Shooting is not permitted into or across roadways, into or across waterways, towards permanent manmade structures, or into or across private property. Safety zones are marked with yellow flagging.
- Park Boundaries:** Boundaries are marked with orange flagging. It is the responsibility of each hunter to know these boundaries and to safely confine all hunting activities to these prescribed areas. Public scrutiny demands you act as responsible hunters. Respect the property of adjacent landowners.
- Field Dressing:** Please do not field dress deer in any mowed or public area; field dress at least 50 feet from any road or trail and cover the entrails with leaf litter. Field dressing should occur out of sight from trails, roads, and off property residences. All items and equipment used to dress a harvested deer must be removed by the hunter upon departure.
- Retrieval:** You are responsible to retrieve your deer from the field. All deer must be brought to the check station prior to leaving the park. Never leave a wounded deer down inside the property. DO NOT leave the property and trespass on private property in an attempt to retrieve a downed deer. Contact the check station, park personnel, or Law Enforcement personnel immediately. The property will not retrieve deer for you.
- Assigned Unit:** There are no assigned hunting units for these management hunts. You may hunt anywhere, except safety zones.
- Meat Handling:** You must take possession of all deer you harvest. All hunters will be responsible for the processing of their own meat. No harvested deer should be left at the park. Please consider donating your deer to Hunt for Hunger ([on.IN.gov/huntforhunger](http://on.IN.gov/huntforhunger)) if your freezer is full by the time of the hunt. When leaving the property with harvested deer, please cover them with a tarp or other suitable material.
- Hunter Image:** Please leave a positive image of deer hunters for other park users by removing any trash at the conclusion of your hunt, picking up all spent shells and casings, and covering any harvested deer while leaving the property. As a general rule, please take out anything you bring into the park. Please practice “leave no trace” ethics to ensure a clean and high quality park.

**Parking:** All hunters are required to enter through the park main gate and leave vehicles inside the park. Do not park on perimeter roads. Park only in parking lots or on roadways. No driving or parking on the Kunkel Lake levee. **DO NOT DRIVE OR PARK VEHICLES OFF THE ROADWAYS.** Keep all four wheels on roadway. You will be responsible for towing charges to remove your vehicle if stuck off the roadway.

**Other Information:** ATVs are not allowed in the park unless you possess a license that clearly authorizes use of an ATV to hunt.

Hunters may be dropped off and picked up by a driver. The driver is not allowed to remain in the park during the hunt.

### TAKING OF ANTLERED & ANTLERLESS DEER

Please keep in mind the purpose of your deer hunting opportunity on Division of State Parks properties is to manage the deer herd in order to prevent overbrowsing and the resulting damage to the properties' vegetation.

Our primary goal is to take does because they have the largest long-term impact on a population; however, we recognize that antlered deer also directly contribute to the grazing impacts on the properties and appreciate your help with their removal. We are concerned that some hunters may be passing up antlerless deer and deer with small antlers. Those hunters who pass on opportunities to remove deer with no or small antlers are actually hurting our ability to reduce the overbrowsing problem. Whenever you have an opportunity to safely make an accurate, well-placed shot, please help us by taking that deer, regardless of the antler size.

We may also have hunters passing up deer because they have filled their freezer. While we do not want deer to be taken that will be wasted, if you do not need the meat from the second or third deer, please consider trying to locate someone prior to our deer management hunt who needs additional deer meat.

Thank you for your help in this important effort.

# OUABACHE STATE PARK

4930 E.S.R. 201 • Bluffton, IN 46714 • (260) 824-0926  
1,104 acres Established 1962

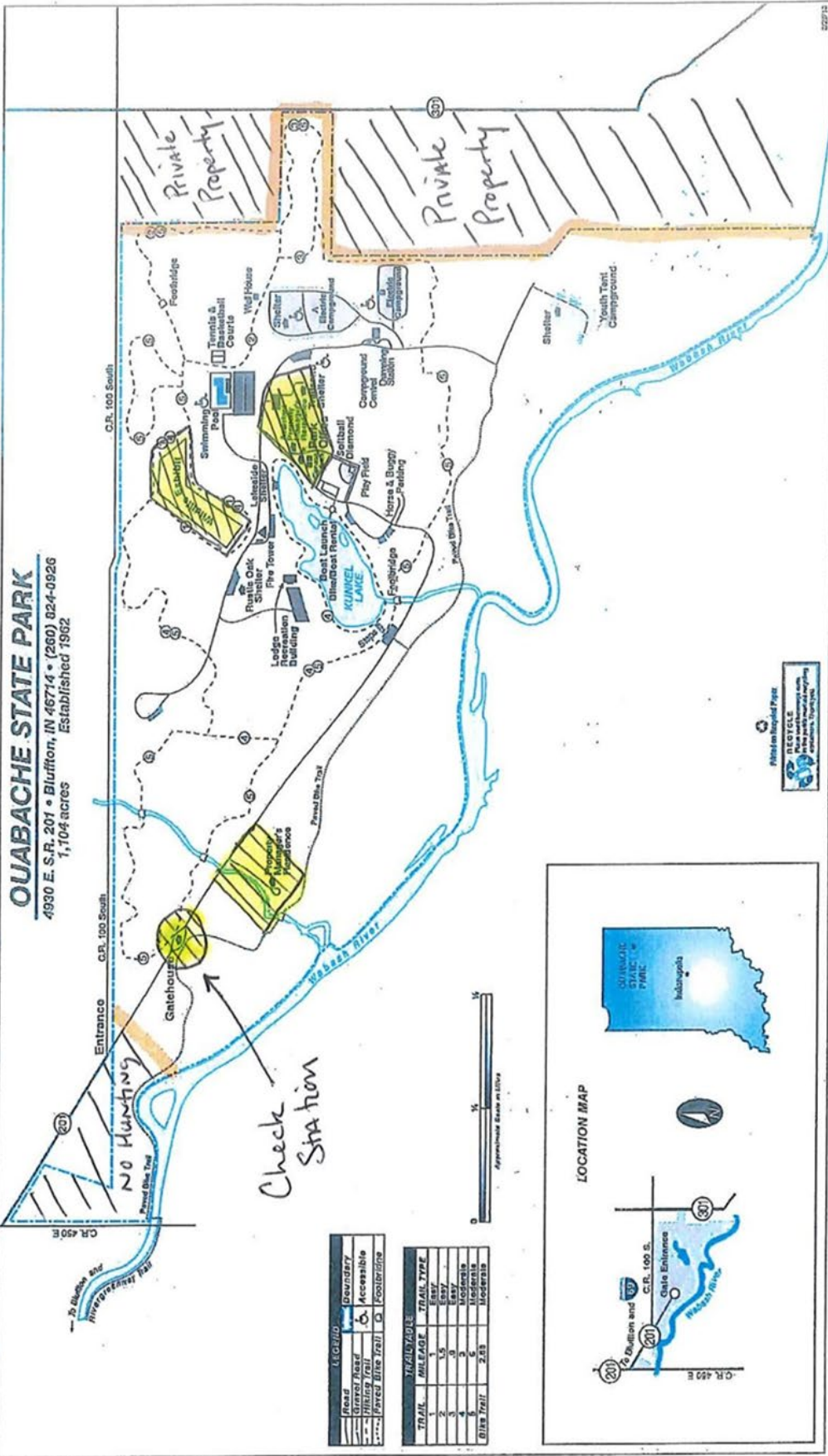

LEGEND	
	Boundary
	Gravel Road
	Hiking Trail
	Paved Bike Trail
	Accessible Footbridge

TRAIL	TRAIL MILEAGE	TRAIL TYPE
1	1	Easy
2	3	Easy
3	3	Easy
4	3	Moderate
5	6	Moderate
6	2.5	Moderate

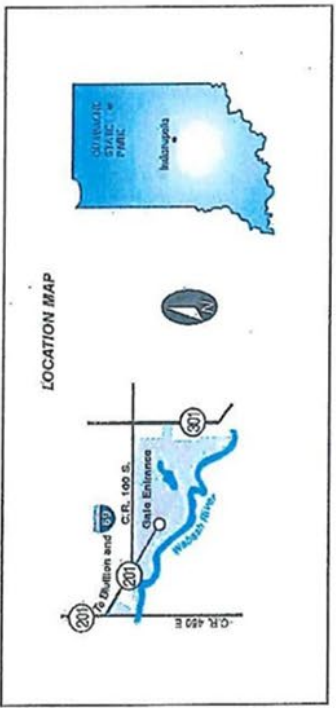



# Deer Transportation Tag



Name: \_\_\_\_\_  
Address: \_\_\_\_\_  
License number: \_\_\_\_\_

Deer harvest information:

Antlered or Antlerless (circle one)

Harvest Date: \_\_\_\_\_  
Harvest Time: \_\_\_\_\_  
Confirmation number\* : \_\_\_\_\_  
\*Only required when using CheckIN Game



# Deer Transportation Tag



Name: \_\_\_\_\_  
Address: \_\_\_\_\_  
License number: \_\_\_\_\_

Deer harvest information:

Antlered or Antlerless (circle one)

Harvest Date: \_\_\_\_\_  
Harvest Time: \_\_\_\_\_  
Confirmation number\* : \_\_\_\_\_  
\*Only required when using CheckIN Game



# Deer Transportation Tag



Name: \_\_\_\_\_  
Address: \_\_\_\_\_  
License number: \_\_\_\_\_

Deer harvest information:

Antlered or Antlerless (circle one)

Harvest Date: \_\_\_\_\_  
Harvest Time: \_\_\_\_\_  
Confirmation number\* : \_\_\_\_\_  
\*Only required when using CheckIN Game